

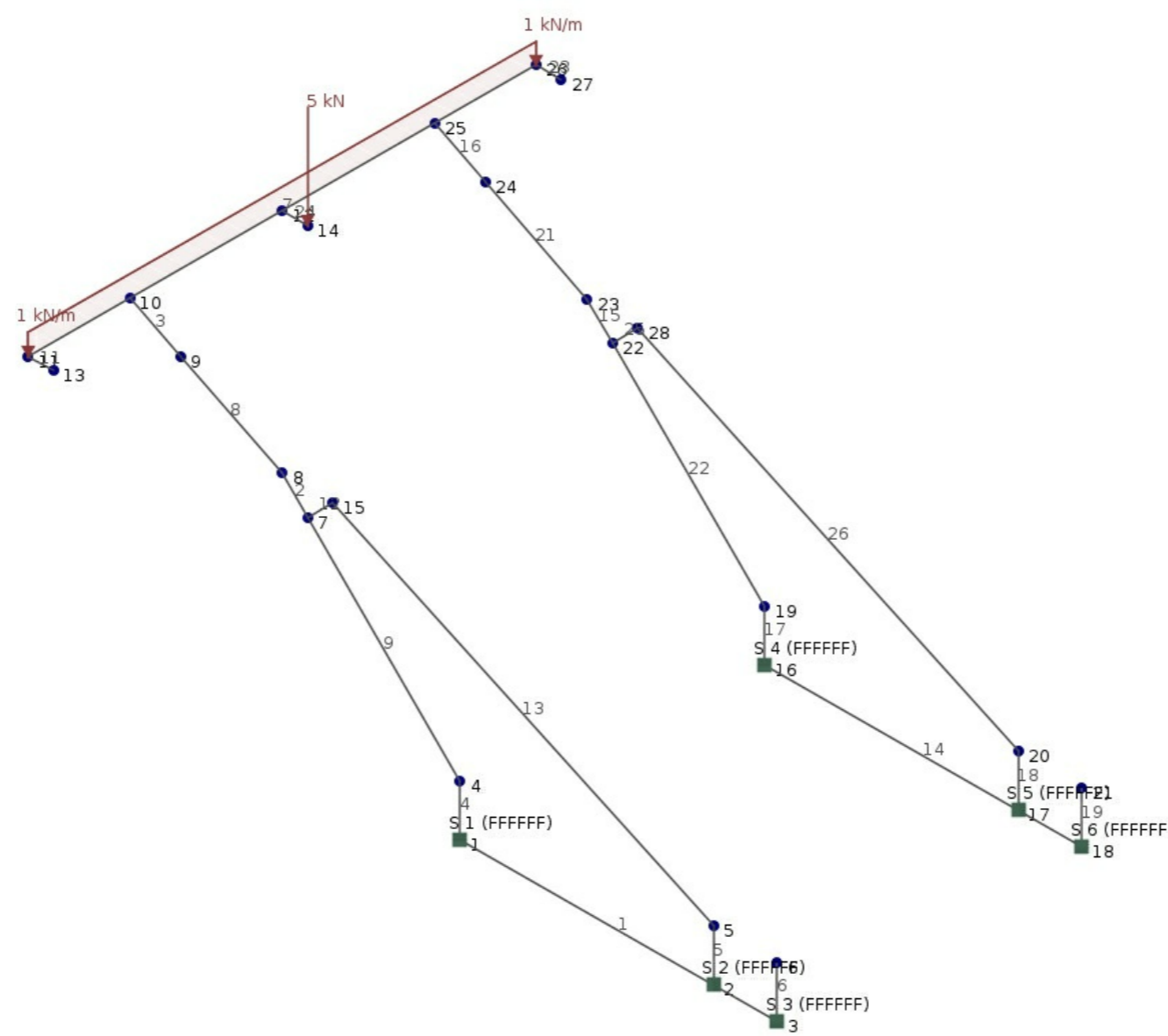

LINEAR STATIC ANALYSIS REPORT

Wed Dec 13 2017 14:30:30 GMT+1100 (AEDT)



File Name: Naval-Frame-FEA
Software: SkyCiv Structural 3D v2.2.7

Included in this Report:

- Job Setup
- Bill of Materials
- Screenshots
- Single Member Reports
- Nodal Results
- Member Results

Job Setup

LINEAR STATIC ANALYSIS REPORT

SkyCiv Structural 3D v2.2.7

Date: Wed Dec 13 2017 14:30:30 GMT+1100 (AEDT)

File Name	Naval-Frame-FEA
Job Name	Empty
Designer	Empty
Job Description	Empty

Length Units	m
Section Length Units	mm
Force Units	kN
Moment and Torsion Units	kNm
Pressure Units	kPa
Material Strength Units	MPa
Material Density Units	kg/m ³
Translation Units	mm
Stress Units	MPa
Nodes	28
Members	24
Plates	0
Meshed Plates	0
Supports	6
Sections	3
Point Loads	1
Distributed Loads	1
Moments	0
Pressures	0
Area Loads	0
Units	Metric
Member Evaluation Points	24
General Constraint	RRRRRR
Total Degrees of Freedom	132
Self Weight	ON

NODE COORDINATES (m)

Node	X Coordinate	Y Coordinate	Z Coordinate
1	0.00000	0.00000	0.00000
2	0.50000	0.00000	0.00000
3	0.62500	0.00000	0.00000
4	0.00000	0.10000	0.00000
5	0.50000	0.10000	0.00000
6	0.62500	0.10000	0.00000
7	-0.30000	0.40000	0.00000
8	-0.35000	0.45000	0.00000
9	-0.55000	0.55000	0.00000
10	-0.65000	0.60000	0.00000
11	-0.65000	0.60000	0.20000
12	-0.65000	0.60000	-0.30000
13	-0.60000	0.60000	0.20000
14	-0.60000	0.60000	-0.30000
15	-0.25000	0.45000	0.00000
16	0.00000	0.00000	-0.60000
17	0.50000	0.00000	-0.60000
18	0.62500	0.00000	-0.60000
19	0.00000	0.10000	-0.60000
20	0.50000	0.10000	-0.60000
21	0.62500	0.10000	-0.60000
22	-0.30000	0.40000	-0.60000
23	-0.35000	0.45000	-0.60000
24	-0.55000	0.55000	-0.60000
25	-0.65000	0.60000	-0.60000
26	-0.65000	0.60000	-0.80000
27	-0.60000	0.60000	-0.80000
28	-0.25000	0.45000	-0.60000

MEMBERS (deg, mm, m)

F=Fixed, R=Released

Member	Node A	Node B	Type	Section	Angle	Node A Fixity	Node B Fixity	Node A Offsets	Node B Offsets	Cable Length	Length
1	1	3	Continuous & Normal	1	90.00000	FFFFFF	FFFFFF	0,0,0	0,0,0	-	0.62500
2	8	7	Continuous & Normal	1	90.00000	FFFFFF	FFFFFF	0,0,0	0,0,0	-	0.07071
3	10	9	Continuous & Normal	1	90.00000	FFFFFF	FFFFFF	0,0,0	0,0,0	-	0.11180
4	4	1	Continuous & Normal	1	90.00000	FFFFFF	FFFFFF	0,0,0	0,0,0	-	0.10000
5	5	2	Continuous & Normal	1	90.00000	FFFFFF	FFFFFF	0,0,0	0,0,0	-	0.10000
6	6	3	Continuous & Normal	1	90.00000	FFFFFF	FFFFFF	0,0,0	0,0,0	-	0.10000
7	11	26	Continuous & Normal	1	0.00000	FFFFFF	FFFFFF	0,0,0	0,0,0	-	1.00000
8	9	8	Continuous & Normal	1	90.00000	FFFFFF	FFFFFF	0,0,0	0,0,0	-	0.22361
9	7	4	Continuous & Normal	1	90.00000	FFFFFF	FFFFFF	0,0,0	0,0,0	-	0.42426
11	11	13	Continuous & Normal	1	0.00000	FFFFFF	FFFFFF	0,0,0	0,0,0	-	0.05000
12	7	15	Continuous & Normal	1	90.00000	FFFFFF	FFFFFF	0,0,0	0,0,0	-	0.07071
13	15	5	Continuous & Normal	1	90.00000	FFFFFF	FFFFFF	0,0,0	0,0,0	-	0.82765
14	16	18	Continuous & Normal	1	90.00000	FFFFFF	FFFFFF	0,0,0	0,0,0	-	0.62500
15	23	22	Continuous & Normal	1	90.00000	FFFFFF	FFFFFF	0,0,0	0,0,0	-	0.07071
16	25	24	Continuous & Normal	1	90.00000	FFFFFF	FFFFFF	0,0,0	0,0,0	-	0.11180
17	19	16	Continuous & Normal	1	90.00000	FFFFFF	FFFFFF	0,0,0	0,0,0	-	0.10000
18	20	17	Continuous & Normal	1	90.00000	FFFFFF	FFFFFF	0,0,0	0,0,0	-	0.10000
19	21	18	Continuous & Normal	1	90.00000	FFFFFF	FFFFFF	0,0,0	0,0,0	-	0.10000
21	24	23	Continuous & Normal	1	90.00000	FFFFFF	FFFFFF	0,0,0	0,0,0	-	0.22361
22	22	19	Continuous & Normal	1	90.00000	FFFFFF	FFFFFF	0,0,0	0,0,0	-	0.42426
23	26	27	Continuous & Normal	1	0.00000	FFFFFF	FFFFFF	0,0,0	0,0,0	-	0.05000
24	12	14	Continuous & Normal	1	0.00000	FFFFFF	FFFFFF	0,0,0	0,0,0	-	0.05000
25	22	28	Continuous & Normal	1	90.00000	FFFFFF	FFFFFF	0,0,0	0,0,0	-	0.07071
26	28	20	Continuous & Normal	1	90.00000	FFFFFF	FFFFFF	0,0,0	0,0,0	-	0.82765

SUPPORTS (kN/m, kNm/rad)

F=Fixed, R=Released, S=Spring

Node	Restraint Code	X Trans Stiffness	Y Trans Stiffness	Z Trans Stiffness	X Rot Stiffness	Y Rot Stiffness	Z Rot Stiffness
1	FFFFFF	-	-	-	-	-	-
2	FFFFFF	-	-	-	-	-	-
3	FFFFFF	-	-	-	-	-	-
16	FFFFFF	-	-	-	-	-	-
17	FFFFFF	-	-	-	-	-	-
18	FFFFFF	-	-	-	-	-	-

MATERIALS (MPa, kg/m³)

Material	Name	Young's Modulus	Density	Poisson's Ratio
1	Structural Steel	199948.00000	7850.00000	0.27000

SECTIONS (mm, mm², mm⁴, deg)

Section	Name	Shape	Depth	Width	Shear Area z (STRESS)	Shear Area y (STRESS)	Shear Area z (TIMO)	Shear Area y (TIMO)	Torsion Radius
1	HSS3x2x1/4	HSS3x2x1/4	76.20000	50.80000	758.46660	408.20826	-	-	34.67750
2	80 x 80	Hollow Rectangular	40.00000	40.00000	159.50649	159.50649	-	-	21.97050
3	50 x 50	Hollow Circular	24.96791	24.93587	72.25663	72.25663	-	-	11.50000

Section	Centroid y	Centroid z	Area	y-Axis Mol	z-Axis Mol	Torsion Constant	Principal Angle
1	38.10000	25.40000	1270.96520	462016.88242	886572.93653	1048903.19251	0.00000
2	20.00000	20.00000	357.40251	81623.63054	81623.63054	136198.00000	0.00000
3	12.48396	12.43587	143.52584	9497.16172	9497.16172	19256.39217	0.00000

POINT LOADS (kN)

Load Group	Node	Member	Position (%)	X Magnitude	Y Magnitude	Z Magnitude
LG	14			0.00000	-5.00000	0.00000

MEMBER DISTRIBUTED LOADS (kN/m)

Load Group	Start Position (%)	End Position (%)	Member	Axes	X Start/End	Y Start/End	Z Start/End
LG	0%	100%	7	global	0.00000	-1.00000	0.00000
					0.00000	-1.00000	0.00000

SELF WEIGHT (g's)

Load Group	X Gravity	Y Gravity	Z Gravity
SW	0.00000	-1.00000	0.00000

Bill of Materials

BILL OF MATERIALS FOR MEMBERS (m, kg)

Section	Material	Quantity	Unit Length	Total Length	Unit Mass	Total Mass
1	1	2	0.62500	1.25000	6.23567	12.47135
1	1	4	0.07071	0.28284	0.70548	2.82192
1	1	2	0.11180	0.22360	1.11544	2.23087
1	1	6	0.10000	0.60000	0.99771	5.98625
1	1	1	1.00000	1.00000	9.97708	9.97708
1	1	2	0.22361	0.44722	2.23097	4.46195
1	1	2	0.42426	0.84852	4.23287	8.46575
1	1	3	0.05000	0.15000	0.49885	1.49656
1	1	2	0.82765	1.65530	8.25753	16.51506
						64.42677

Screenshots

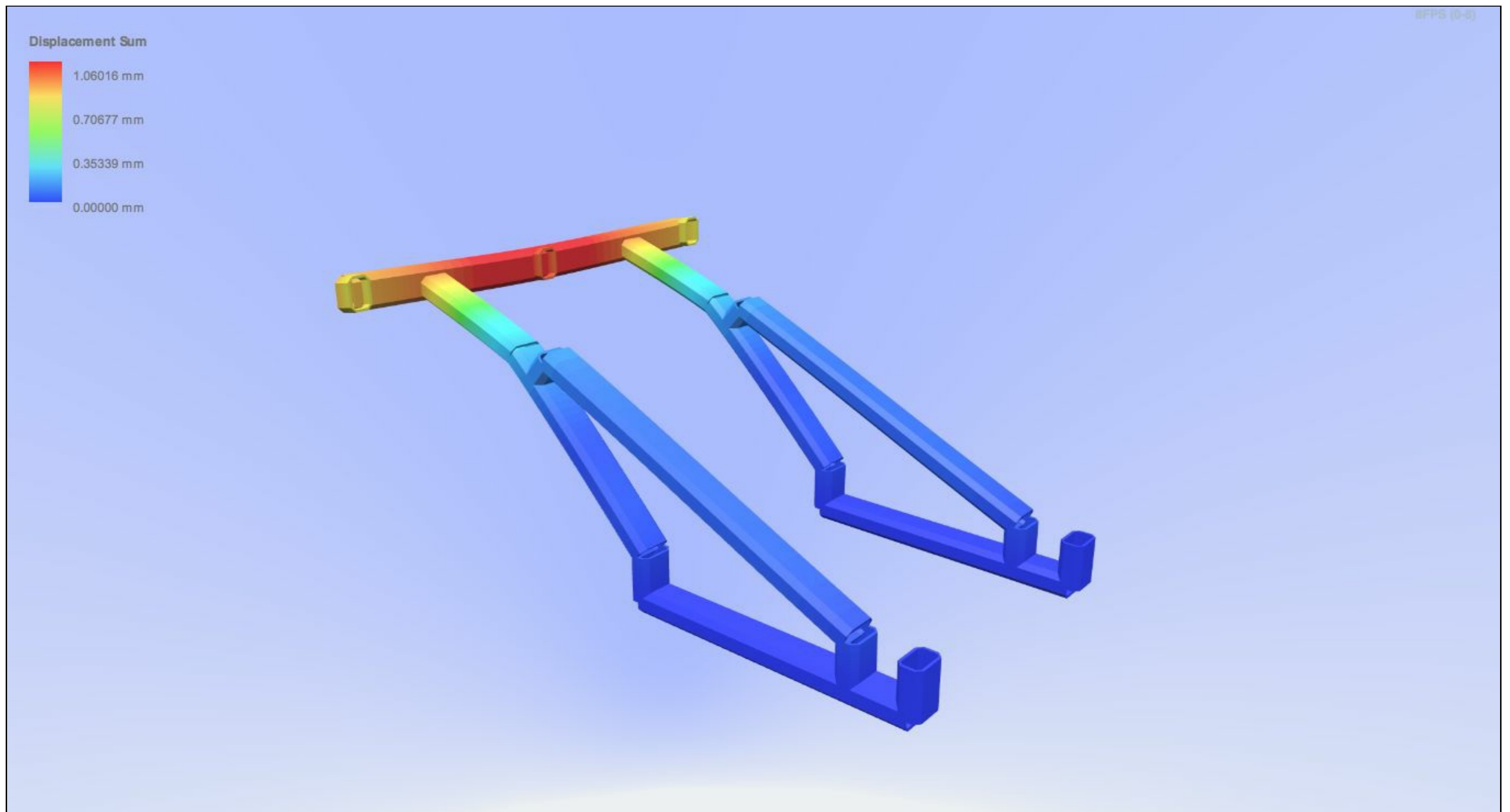

Displacement Sum.jpg

Member 7

Member Summary Table	
Member Number	7
Node A	11 (-0.65, 0.6, 0.2)
Node B	26 (-0.65, 0.6, -0.8)
Member Length	1.00000 m
Section Name	HSS3x2x1/4
Section No	1
Section Rotation	0 degrees
Fixity A	FFFFFF
Fixity B	FFFFFF
Buckling	Not Analysed
Reaction A (kN,kNm)	No Support at this Location
Reaction B (kN,kNm)	No Support at this Location

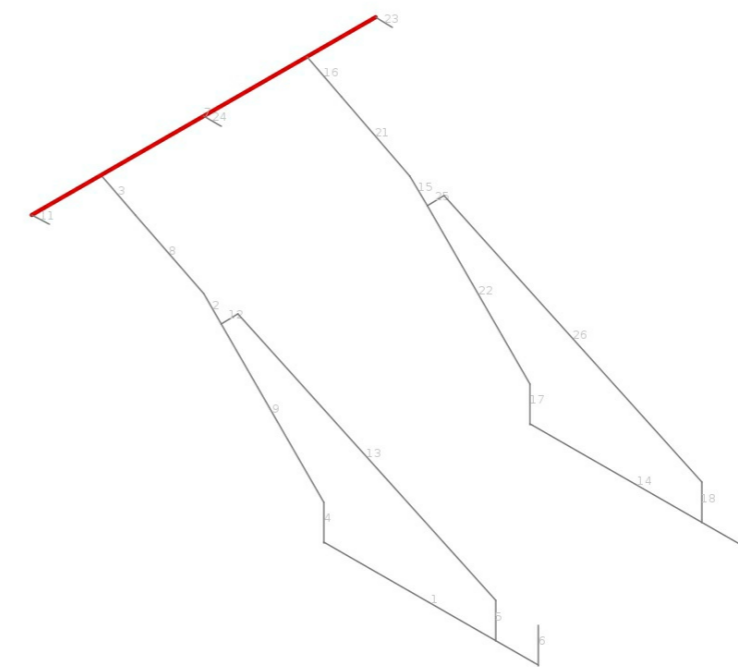

Result	Max Location (m,MPa)	Result	Min Location (m,MPa)	Result
Shear Stress in Y	0.20000	3.73358	0.80000	-3.73358
Shear Stress in Z	0.55000	0.00000	1.00000	-0.00000
Bending Stress (Bottom) in Y	1.00000	0.00000	0.75000	-2.50835
Bending Stress (Bottom) in Z	0.20000	5.24872	0.50000	-29.13673
Combined Stress (Bottom) in Y	1.00000	0.00000	0.75000	-2.39221
Combined Stress (Bottom) in Z	0.20000	5.36486	0.50000	-29.02059
Bending Stress (Top) in Y	0.75000	2.50835	1.00000	-0.00000
Bending Stress (Bottom) in Z	0.50000	29.13673	0.20000	-5.24872
Combined Stress (Top) in Y	0.75000	2.62449	1.00000	-0.00000
Combined Stress (Top) in Z	0.50000	29.25287	0.20000	-5.13258
Axial Stress	0.50000	0.11614	1.00000	-0.00000
Torsion Stress	0.50000	4.13461	0.20000	-4.13461

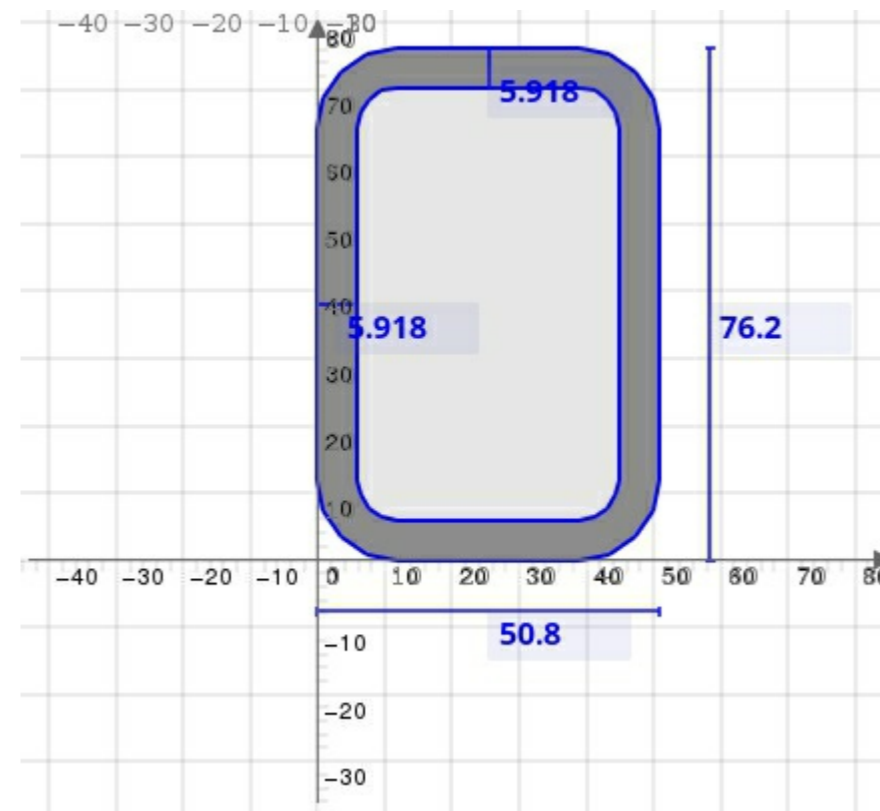

Geometric Properties		
A	1270.9652	mm ²
C _z	25.4	mm
C _y	38.1	mm
Bending Properties		
I _z	886572.93653	mm ⁴
I _y	462016.88242	mm ⁴
α	0	°
Shear Properties		
A _z	758.4666	mm ²
A _y	408.20826	mm ²
Q _z	14878.37887	mm ³
Q _y	11176.76922	mm ³
Torsion Properties		
J	1048903.19251	mm ⁴
r	34.6775	mm

Shape	Material	E (MPa)	ν	ρ (kg/m ³)
HSS3x2x1/4	Structural Steel	199948	0.27	7850

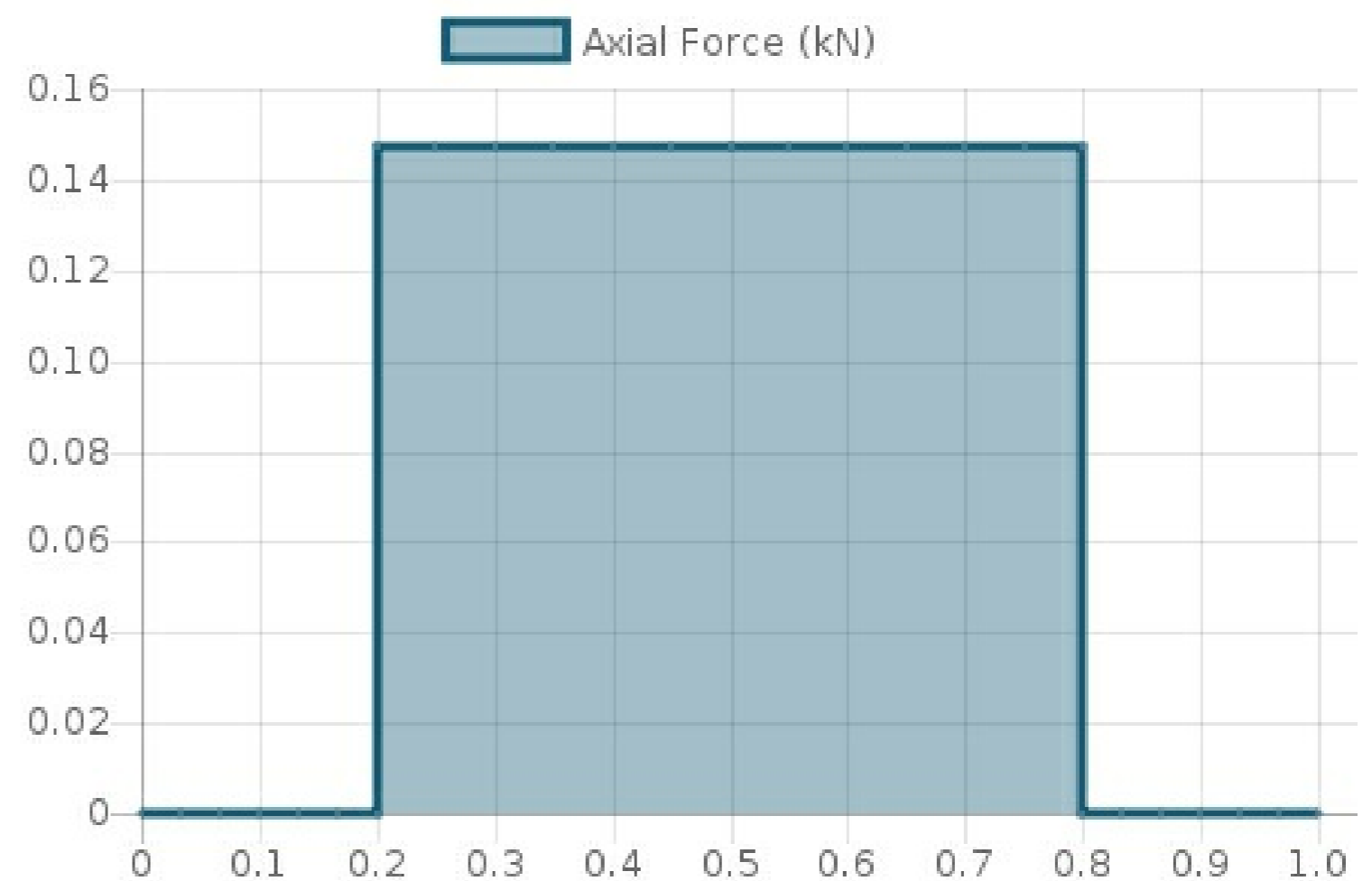
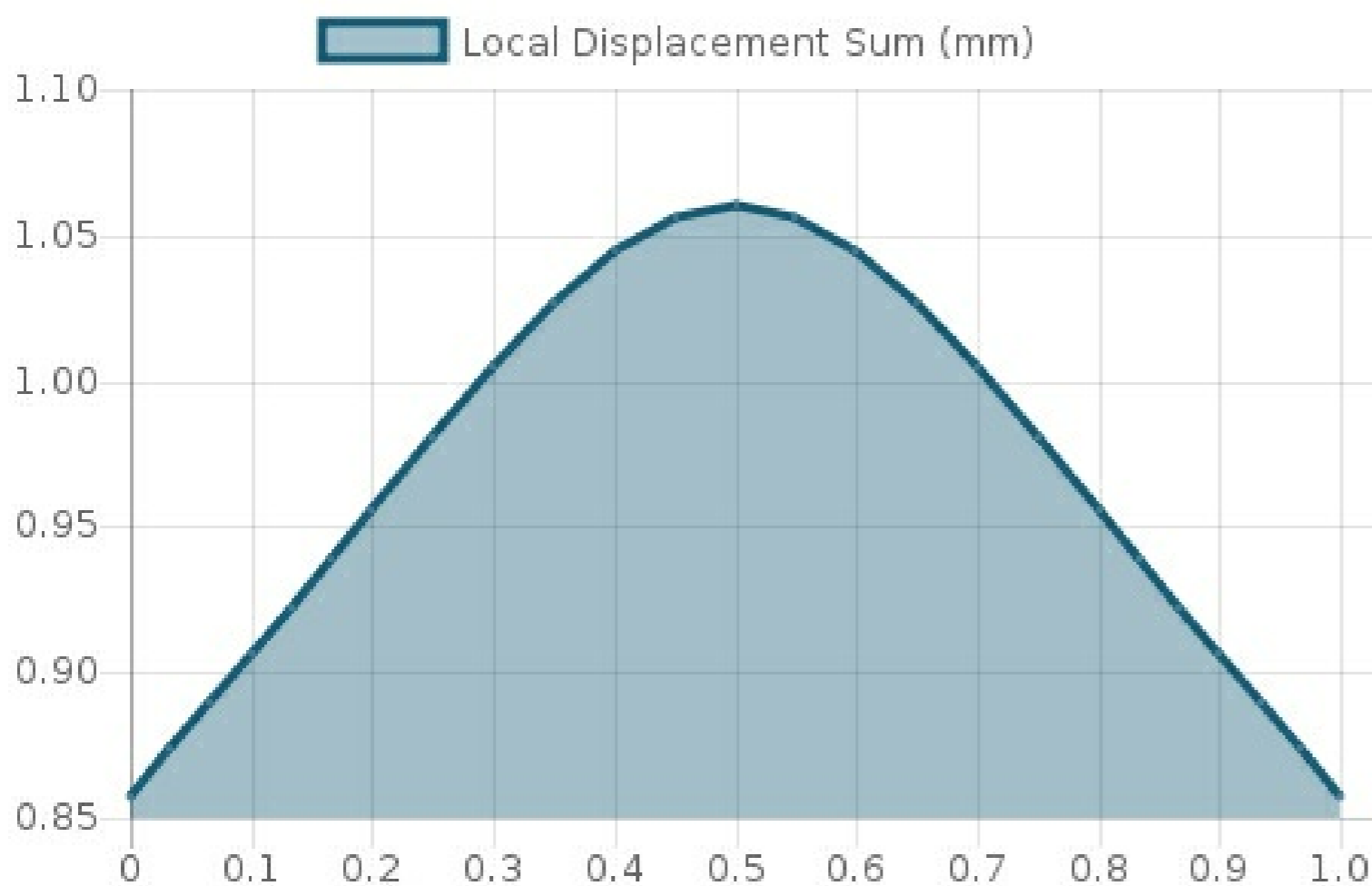
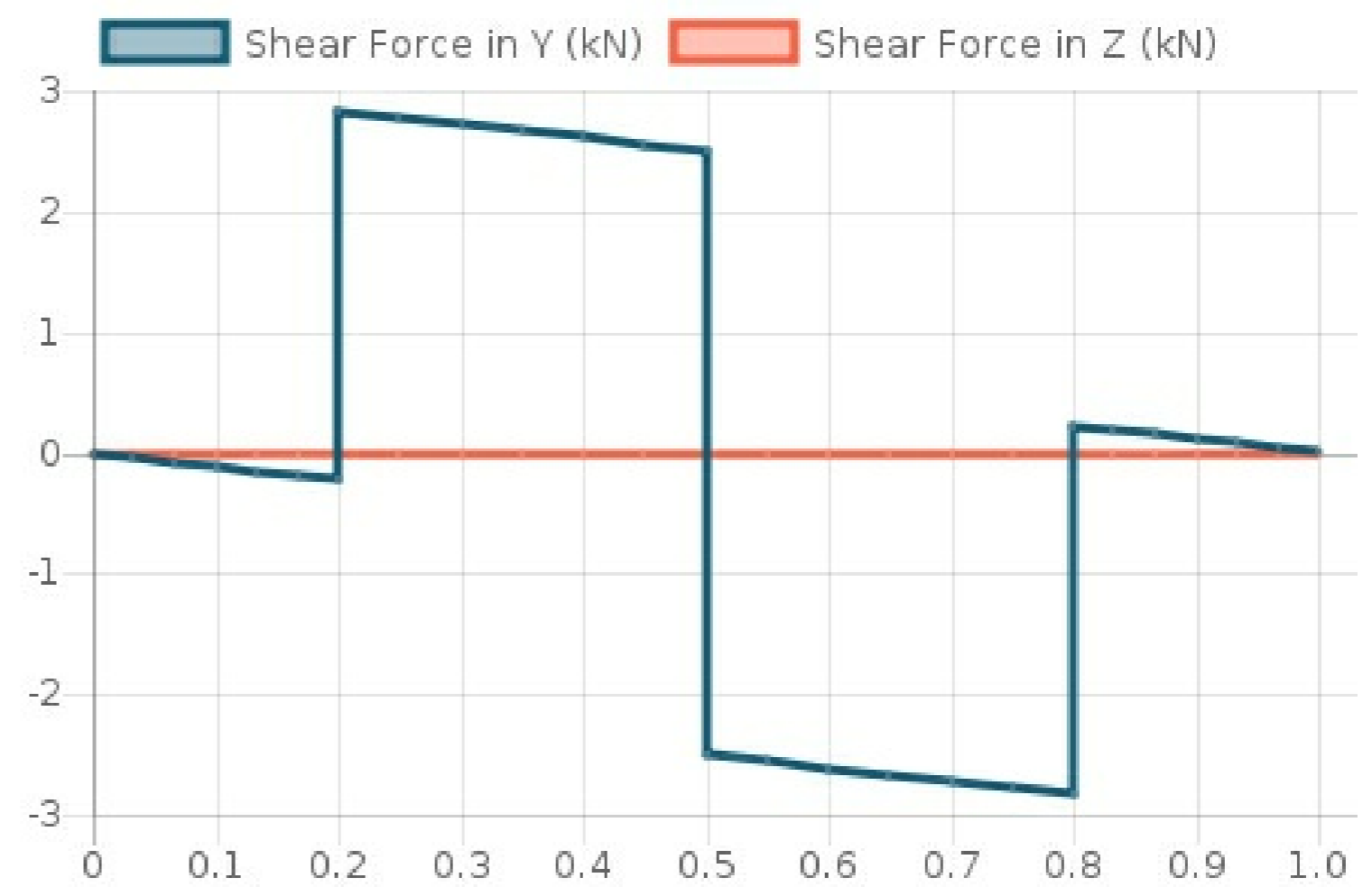
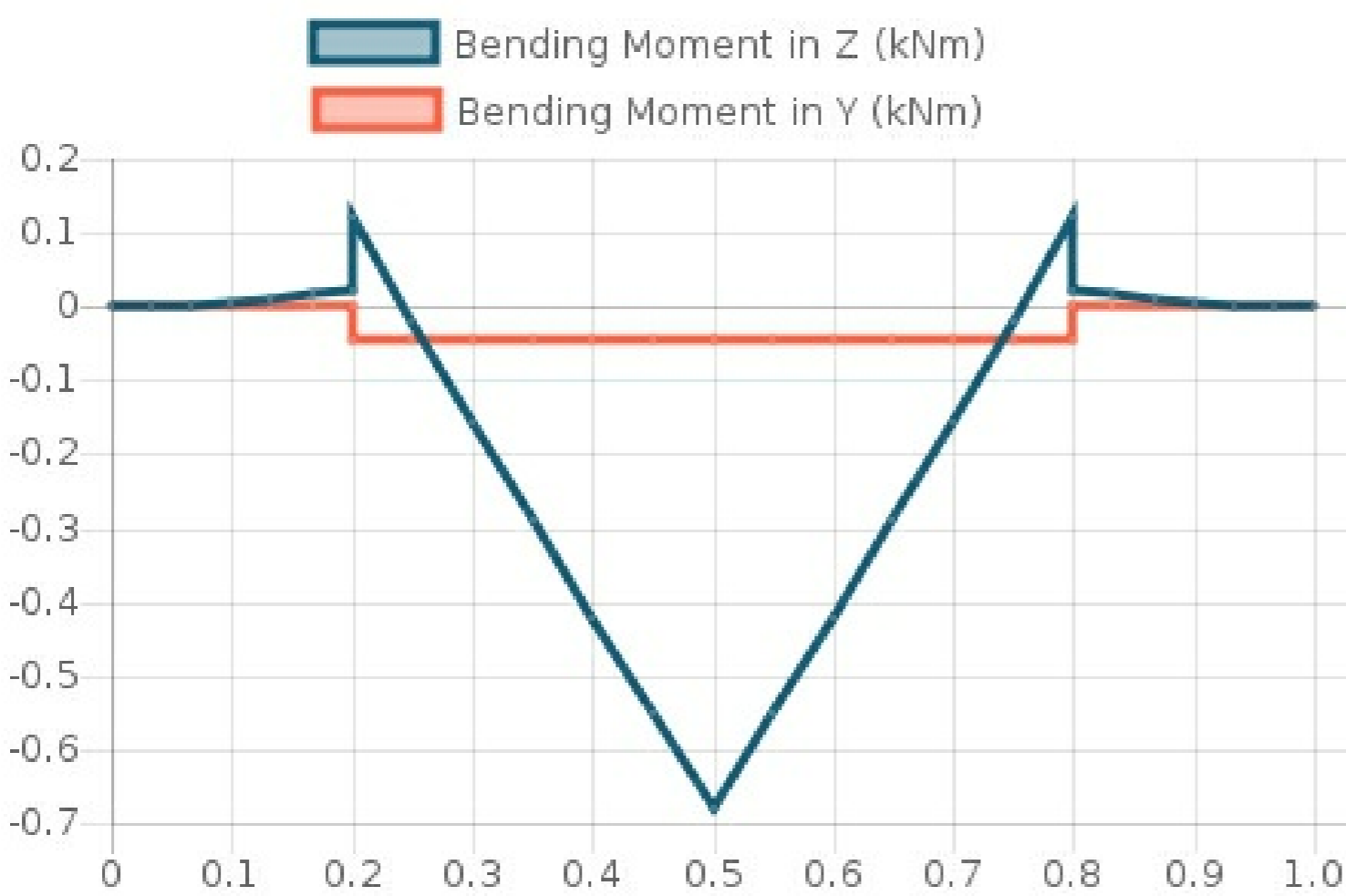

Nodal Results

NODE REACTIONS (kN, kNm)

Node	X Force	Y Force	Z Force	X Moment	Y Moment	Z Moment
1	-7.05316	6.91509	-0.18541	-0.01124	-0.03307	0.52950
2	7.05316	-3.61509	0.03780	0.02187	0.00165	-0.57970
3	0.00000	0.01590	0.00000	0.00000	0.00000	-0.00013
16	-7.05316	6.91509	0.18541	0.01124	0.03307	0.52950
17	7.05316	-3.61509	-0.03780	-0.02187	-0.00165	-0.57970
18	0.00000	0.01590	0.00000	0.00000	0.00000	-0.00013
Reaction Sum	-0.00000	6.63181	0.00000			
Load Sum	0.00000	-6.63181	0.00000			
Equilibrium	-0.00000	0.00000	0.00000			

MEMBER END FORCES AND MOMENTS (kN, kNm)

Member	Node	Axial Force	Y Shear	Z Shear	X Torsion	Y Moment	Z Moment
1	1	0.00000	0.00000	-0.02446	0.00000	0.00204	-0.00000
	3	0.00000	-0.00000	0.00612	0.00000	0.00013	-0.00000
2	8	2.18431	0.14761	2.18431	-0.05354	0.79662	-0.05544
	7	2.18920	0.14761	2.18920	-0.05354	0.95124	-0.04500
3	10	1.36680	0.14761	2.73360	-0.06832	-0.12518	-0.08517
	9	1.37169	0.14761	2.74339	-0.06832	0.18099	-0.06867
4	4	6.88085	0.18541	-7.05316	-0.03307	0.17785	-0.00730
	1	6.89063	0.18541	-7.05316	-0.03307	-0.52747	0.01124
5	5	-3.65545	-0.03780	7.05316	0.00165	-0.12752	-0.01809
	2	-3.64566	-0.03780	7.05316	0.00165	0.57779	-0.02187
6	6	0.00000	0.00000	0.00000	0.00000	0.00000	0.00000
	3	0.00978	0.00000	0.00000	0.00000	0.00000	0.00000
7	11	0.00000	-0.00489	0.00000	0.00012	0.00000	-0.00000
	26	-0.00000	0.00489	-0.00000	-0.00012	-0.00000	-0.00000
8	9	1.37169	0.14761	2.74339	-0.06832	0.18099	-0.06867
	8	1.38148	0.14761	2.76295	-0.06832	0.79662	-0.03566
9	7	9.82348	0.18541	-0.15120	-0.02855	0.23577	-0.06044
	4	9.85283	0.18541	-0.12184	-0.02855	0.17785	0.01822
11	11	0.00000	0.00489	0.00000	0.00000	-0.00000	-0.00012
	13	0.00000	-0.00000	0.00000	0.00000	-0.00000	-0.00000
12	7	-2.34039	-0.03780	-7.63428	0.01544	0.71547	0.02499
	15	-2.34529	-0.03780	-7.62939	0.01544	0.17582	0.02232
13	15	-7.97153	-0.03780	-0.40321	-0.01570	0.17582	0.02214
	5	-7.93729	-0.03780	-0.32982	-0.01570	-0.12752	-0.00915
14	16	0.00000	0.00000	-0.02446	0.00000	0.00204	-0.00000
	18	0.00000	-0.00000	0.00612	0.00000	0.00013	-0.00000
15	23	2.18431	-0.14761	2.18431	0.05354	0.79662	0.05544
	22	2.18920	-0.14761	2.18920	0.05354	0.95124	0.04500
16	25	1.36680	-0.14761	2.73360	0.06832	-0.12518	0.08517
	24	1.37169	-0.14761	2.74339	0.06832	0.18099	0.06867
17	19	6.88085	-0.18541	-7.05316	0.03307	0.17785	0.00730
	16	6.89063	-0.18541	-7.05316	0.03307	-0.52747	-0.01124
18	20	-3.65545	0.03780	7.05316	-0.00165	-0.12752	0.01809
	17	-3.64566	0.03780	7.05316	-0.00165	0.57779	0.02187
19	21	0.00000	0.00000	0.00000	0.00000	0.00000	0.00000
	18	0.00978	0.00000	0.00000	0.00000	0.00000	0.00000
21	24	1.37169	-0.14761	2.74339	0.06832	0.18099	0.06867
	23	1.38148	-0.14761	2.76295	0.06832	0.79662	0.03566
22	22	9.82348	-0.18541	-0.15120	0.02855	0.23577	0.06044
	19	9.85283	-0.18541	-0.12184	0.02855	0.17785	-0.01822
23	26	0.00000	0.00489	0.00000	0.00000	-0.00000	-0.00012
	27	0.00000	0.00000	0.00000	0.00000	-0.00000	0.00000
24	12	0.00000	5.00489	-0.00000	-0.00000	-0.00000	-0.25012
	14	0.00000	5.00000	-0.00000	-0.00000	-0.00000	-0.00000
25	22	-2.34039	0.03780	-7.63428	-0.01544	0.71547	-0.02499
	28	-2.34529	0.03780	-7.62939	-0.01544	0.17582	-0.02232
26	28	-7.97153	0.03780	-0.40321	0.01570	0.17582	-0.02214
	20	-7.93729	0.03780	-0.32982	0.01570	-0.12752	0.00915

NODAL DISPLACEMENTS (mm)

Node	X Translation	Y Translation	Z Translation	Total Translation
1	0.00000	0.00000	0.00000	0.00000
2	0.00000	0.00000	0.00000	0.00000
3	0.00000	0.00000	0.00000	0.00000
4	0.01582	-0.00271	0.00014	0.01605
5	-0.01855	0.00144	-0.00058	0.01861
6	0.00000	-0.00000	0.00000	0.00000
7	-0.05090	-0.09266	0.00843	0.10606
8	-0.10548	-0.14810	0.00623	0.18192
9	-0.31840	-0.57665	0.00641	0.65874
10	-0.45059	-0.84239	-0.00017	0.95533
11	-0.42096	-0.74684	-0.00017	0.85731
12	-0.47282	-0.94889	-0.00000	1.06016
13	-0.42096	-0.61482	-0.00758	0.74517
14	-0.47282	-0.84075	-0.00000	0.96458
15	-0.07798	-0.06466	-0.00355	0.10136
16	0.00000	0.00000	0.00000	0.00000
17	0.00000	0.00000	0.00000	0.00000
18	0.00000	0.00000	0.00000	0.00000
19	0.01582	-0.00271	-0.00014	0.01605
20	-0.01855	0.00144	0.00058	0.01861
21	0.00000	-0.00000	0.00000	0.00000
22	-0.05090	-0.09266	-0.00843	0.10606
23	-0.10548	-0.14810	-0.00623	0.18192
24	-0.31840	-0.57665	-0.00641	0.65874
25	-0.45059	-0.84239	0.00017	0.95533
26	-0.42096	-0.74684	0.00017	0.85731
27	-0.42096	-0.61482	0.00758	0.74517
28	-0.07798	-0.06466	0.00355	0.10136

Member Results

INTERNAL MEMBER FORCES AND MOMENTS (m, kN, kNm)

Member	Station Location	Axial Force	Y Shear	Z Shear	X Torsion	Y Moment	Z Moment
1	0.00000	0.00000	0.00000	-0.02446	0.00000	0.00204	-0.00000
1	0.04167	0.00000	0.00000	-0.02038	0.00000	0.00110	-0.00000
1	0.08333	0.00000	0.00000	-0.01631	0.00000	0.00034	-0.00000
1	0.12500	0.00000	0.00000	-0.01223	0.00000	-0.00025	0.00000
1	0.16667	0.00000	0.00000	-0.00815	0.00000	-0.00068	0.00000
1	0.20833	0.00000	0.00000	-0.00408	0.00000	-0.00093	0.00000
1	0.25000	0.00000	-0.00000	-0.00000	0.00000	-0.00102	0.00000
1	0.29167	0.00000	-0.00000	0.00408	0.00000	-0.00093	0.00000
1	0.33333	0.00000	-0.00000	0.00815	0.00000	-0.00068	0.00000
1	0.37500	0.00000	-0.00000	0.01223	0.00000	-0.00025	0.00000
1	0.41667	0.00000	-0.00000	0.01631	0.00000	0.00034	-0.00000
1	0.45833	0.00000	-0.00000	0.02038	0.00000	0.00110	-0.00000
1	0.50000	0.00000	0.00000	-0.00612	0.00000	0.00013	-0.00000
1	0.51042	0.00000	0.00000	-0.00510	0.00000	0.00007	-0.00000
1	0.52083	0.00000	0.00000	-0.00408	0.00000	0.00002	-0.00000
1	0.53125	0.00000	0.00000	-0.00306	0.00000	-0.00002	0.00000
1	0.54167	0.00000	0.00000	-0.00204	0.00000	-0.00004	0.00000
1	0.55208	0.00000	0.00000	-0.00102	0.00000	-0.00006	0.00000
1	0.56250	0.00000	-0.00000	-0.00000	0.00000	-0.00006	0.00000
1	0.57292	0.00000	-0.00000	0.00102	0.00000	-0.00006	0.00000
1	0.58333	0.00000	-0.00000	0.00204	0.00000	-0.00004	0.00000
1	0.59375	0.00000	-0.00000	0.00306	0.00000	-0.00002	0.00000
1	0.60417	0.00000	-0.00000	0.00408	0.00000	0.00002	-0.00000
1	0.61458	0.00000	-0.00000	0.00510	0.00000	0.00007	-0.00000
1	0.62500	0.00000	-0.00000	0.00612	0.00000	0.00013	-0.00000
2	0.00000	2.18431	0.14761	2.18431	-0.05354	0.79662	-0.05544
2	0.00295	2.18451	0.14761	2.18451	-0.05354	0.80305	-0.05500
2	0.00589	2.18471	0.14761	2.18471	-0.05354	0.80949	-0.05457
2	0.00884	2.18492	0.14761	2.18492	-0.05354	0.81593	-0.05413
2	0.01179	2.18512	0.14761	2.18512	-0.05354	0.82236	-0.05370
2	0.01473	2.18533	0.14761	2.18533	-0.05354	0.82880	-0.05326
2	0.01768	2.18553	0.14761	2.18553	-0.05354	0.83524	-0.05283
2	0.02062	2.18573	0.14761	2.18573	-0.05354	0.84168	-0.05239
2	0.02357	2.18594	0.14761	2.18594	-0.05354	0.84812	-0.05196
2	0.02652	2.18614	0.14761	2.18614	-0.05354	0.85456	-0.05153
2	0.02946	2.18635	0.14761	2.18635	-0.05354	0.86100	-0.05109
2	0.03241	2.18655	0.14761	2.18655	-0.05354	0.86744	-0.05066
2	0.03536	2.18675	0.14761	2.18675	-0.05354	0.87389	-0.05022
2	0.03830	2.18696	0.14761	2.18696	-0.05354	0.88033	-0.04979
2	0.04125	2.18716	0.14761	2.18716	-0.05354	0.88677	-0.04935
2	0.04419	2.18736	0.14761	2.18736	-0.05354	0.89322	-0.04892
2	0.04714	2.18757	0.14761	2.18757	-0.05354	0.89966	-0.04848
2	0.05009	2.18777	0.14761	2.18777	-0.05354	0.90611	-0.04805
2	0.05303	2.18798	0.14761	2.18798	-0.05354	0.91255	-0.04761
2	0.05598	2.18818	0.14761	2.18818	-0.05354	0.91900	-0.04718
2	0.05893	2.18838	0.14761	2.18838	-0.05354	0.92545	-0.04674
2	0.06187	2.18859	0.14761	2.18859	-0.05354	0.93190	-0.04631
2	0.06482	2.18879	0.14761	2.18879	-0.05354	0.93834	-0.04587
2	0.06776	2.18899	0.14761	2.18899	-0.05354	0.94479	-0.04544
2	0.07071	2.18920	0.14761	2.18920	-0.05354	0.95124	-0.04500
3	0.00000	1.36680	0.14761	2.73360	-0.06832	-0.12518	-0.08517
3	0.00466	1.36700	0.14761	2.73401	-0.06832	-0.11245	-0.08449
3	0.00932	1.36721	0.14761	2.73442	-0.06832	-0.09971	-0.08380
3	0.01398	1.36741	0.14761	2.73482	-0.06832	-0.08697	-0.08311
3	0.01863	1.36762	0.14761	2.73523	-0.06832	-0.07423	-0.08242
3	0.02329	1.36782	0.14761	2.73564	-0.06832	-0.06149	-0.08173
3	0.02795	1.36802	0.14761	2.73605	-0.06832	-0.04874	-0.08105
3	0.03261	1.36823	0.14761	2.73645	-0.06832	-0.03600	-0.08036
3	0.03727	1.36843	0.14761	2.73686	-0.06832	-0.02325	-0.07967
3	0.04193	1.36864	0.14761	2.73727	-0.06832	-0.01050	-0.07898
3	0.04658	1.36884	0.14761	2.73768	-0.06832	0.00226	-0.07830
3	0.05124	1.36904	0.14761	2.73809	-0.06832	0.01501	-0.07761
3	0.05590	1.36925	0.14761	2.73849	-0.06832	0.02777	-0.07692
3	0.06056	1.36945	0.14761	2.73890	-0.06832	0.04052	-0.07623
3	0.06522	1.36965	0.14761	2.73931	-0.06832	0.05328	-0.07555
3	0.06988	1.36986	0.14761	2.73972	-0.06832	0.06605	-0.07486
3	0.07454	1.37006	0.14761	2.74012	-0.06832	0.07881	-0.07417
3	0.07919	1.37027	0.14761	2.74053	-0.06832	0.09158	-0.07348
3	0.08385	1.37047	0.14761	2.74094	-0.06832	0.10434	-0.07280
3	0.08851	1.37067	0.14761	2.74135	-0.06832	0.11711	-0.07211
3	0.09317	1.37088	0.14761	2.74175	-0.06832	0.12988	-0.07142
3	0.09783	1.37108	0.14761	2.74216	-0.06832	0.14266	-0.07073

26	0.17243	-0.05324	-0.02444	0.00597	0.05889	0.00012	-0.00006	0.00015
26	0.20691	-0.05035	-0.02079	0.00611	0.05481	0.00011	-0.00006	0.00011
26	0.24140	-0.04797	-0.01824	0.00615	0.05169	0.00011	-0.00005	0.00008
26	0.27588	-0.04603	-0.01664	0.00610	0.04932	0.00010	-0.00005	0.00005
26	0.31037	-0.04446	-0.01583	0.00597	0.04757	0.00010	-0.00004	0.00003
26	0.34485	-0.04319	-0.01566	0.00577	0.04630	0.00009	-0.00004	0.00001
26	0.37934	-0.04215	-0.01598	0.00551	0.04541	0.00009	-0.00003	-0.00000
26	0.41382	-0.04127	-0.01665	0.00520	0.04480	0.00008	-0.00003	-0.00001
26	0.44831	-0.04047	-0.01750	0.00485	0.04436	0.00008	-0.00002	-0.00001
26	0.48279	-0.03970	-0.01841	0.00446	0.04399	0.00007	-0.00002	-0.00001
26	0.51728	-0.03889	-0.01921	0.00405	0.04356	0.00007	-0.00002	-0.00001
26	0.55176	-0.03796	-0.01977	0.00361	0.04295	0.00006	-0.00001	0.00000
26	0.58625	-0.03685	-0.01994	0.00317	0.04202	0.00006	-0.00001	0.00002
26	0.62074	-0.03550	-0.01959	0.00273	0.04063	0.00005	-0.00001	0.00004
26	0.65522	-0.03383	-0.01856	0.00230	0.03866	0.00004	-0.00001	0.00006
26	0.68971	-0.03178	-0.01673	0.00189	0.03597	0.00004	-0.00000	0.00009
26	0.72419	-0.02930	-0.01395	0.00150	0.03248	0.00003	-0.00000	0.00012
26	0.75868	-0.02630	-0.01009	0.00115	0.02819	0.00002	-0.00000	0.00016
26	0.79316	-0.02274	-0.00500	0.00084	0.02330	0.00002	0.00000	0.00020
26	0.82765	-0.01855	0.00144	0.00058	0.01861	0.00001	0.00000	0.00024

MEMBER LOCAL DISPLACEMENTS (m, mm, rad)

Member	Station Location	Local X Translation	Local Y Translation	Local Z Translation	Local X Rotation	Local Y Rotation	Local Z Rotation
1	0.00000	0.00000	0.00000	0.00000	0.00000	0.00000	0.00000
1	0.04167	0.00000	-0.00000	0.00002	0.00000	-0.00000	-0.00000
1	0.08333	0.00000	-0.00000	0.00005	0.00000	-0.00000	-0.00000
1	0.12500	0.00000	-0.00000	0.00010	0.00000	-0.00000	-0.00000
1	0.16667	0.00000	-0.00000	0.00014	0.00000	-0.00000	-0.00000
1	0.20833	0.00000	-0.00000	0.00016	0.00000	-0.00000	-0.00000
1	0.25000	0.00000	-0.00000	0.00017	0.00000	0.00000	0.00000
1	0.29167	0.00000	-0.00000	0.00016	0.00000	0.00000	0.00000
1	0.33333	0.00000	-0.00000	0.00014	0.00000	0.00000	0.00000
1	0.37500	0.00000	-0.00000	0.00010	0.00000	0.00000	0.00000
1	0.41667	0.00000	-0.00000	0.00005	0.00000	0.00000	0.00000
1	0.45833	0.00000	-0.00000	0.00002	0.00000	0.00000	0.00000
1	0.50000	0.00000	0.00000	0.00000	0.00000	0.00000	0.00000
1	0.51042	0.00000	-0.00000	0.00000	0.00000	-0.00000	-0.00000
1	0.52083	0.00000	-0.00000	0.00000	0.00000	-0.00000	-0.00000
1	0.53125	0.00000	-0.00000	0.00000	0.00000	-0.00000	-0.00000
1	0.54167	0.00000	-0.00000	0.00000	0.00000	-0.00000	-0.00000
1	0.55208	0.00000	-0.00000	0.00000	0.00000	-0.00000	-0.00000
1	0.56250	0.00000	-0.00000	0.00000	0.00000	0.00000	0.00000
1	0.57292	0.00000	-0.00000	0.00000	0.00000	0.00000	0.00000
1	0.58333	0.00000	-0.00000	0.00000	0.00000	0.00000	0.00000
1	0.59375	0.00000	-0.00000	0.00000	0.00000	0.00000	0.00000
1	0.60417	0.00000	-0.00000	0.00000	0.00000	0.00000	0.00000
1	0.61458	0.00000	-0.00000	0.00000	0.00000	0.00000	0.00000
1	0.62500	0.00000	0.00000	0.00000	0.00000	0.00000	0.00000
2	0.00000	0.03014	0.00623	0.17930	-0.00022	0.00142	0.00004
2	0.00295	0.03011	0.00635	0.17514	-0.00022	0.00140	0.00004
2	0.00589	0.03009	0.00647	0.17106	-0.00022	0.00137	0.00004
2	0.00884	0.03006	0.00658	0.16705	-0.00021	0.00135	0.00004
2	0.01179	0.03004	0.00670	0.16312	-0.00021	0.00132	0.00004
2	0.01473	0.03001	0.00681	0.15926	-0.00021	0.00130	0.00004
2	0.01768	0.02999	0.00691	0.15549	-0.00021	0.00127	0.00004
2	0.02062	0.02996	0.00702	0.15179	-0.00021	0.00124	0.00004
2	0.02357	0.02994	0.00712	0.14817	-0.00020	0.00121	0.00003
2	0.02652	0.02991	0.00722	0.14463	-0.00020	0.00119	0.00003
2	0.02946	0.02989	0.00732	0.14117	-0.00020	0.00116	0.00003
2	0.03241	0.02986	0.00741	0.13779	-0.00020	0.00113	0.00003
2	0.03536	0.02983	0.00751	0.13449	-0.00020	0.00111	0.00003
2	0.03830	0.02981	0.00760	0.13128	-0.00020	0.00108	0.00003
2	0.04125	0.02978	0.00768	0.12815	-0.00019	0.00105	0.00003
2	0.04419	0.02976	0.00777	0.12510	-0.00019	0.00102	0.00003
2	0.04714	0.02973	0.00785	0.12213	-0.00019	0.00099	0.00003
2	0.05009	0.02971	0.00793	0.11925	-0.00019	0.00096	0.00003
2	0.05303	0.02968	0.00801	0.11646	-0.00019	0.00093	0.00003
2	0.05598	0.02966	0.00808	0.11375	-0.00018	0.00090	0.00003
2	0.05893	0.02963	0.00816	0.11113	-0.00018	0.00088	0.00002
2	0.06187	0.02961	0.00823	0.10859	-0.00018	0.00085	0.00002
2	0.06482	0.02958	0.00830	0.10614	-0.00018	0.00082	0.00002
2	0.06776	0.02956	0.00836	0.10378	-0.00018	0.00079	0.00002
2	0.07071	0.02953	0.00843	0.10151	-0.00017	0.00076	0.00002
3	0.00000	-0.02630	-0.00017	0.95497	-0.00050	0.00264	0.00008
3	0.00466	-0.02632	0.00021	0.94265	-0.00050	0.00265	0.00008
3	0.00932	-0.02635	0.00059	0.93031	-0.00049	0.00265	0.00008
3	0.01398	-0.02637	0.00095	0.91794	-0.00049	0.00266	0.00008
3	0.01863	-0.02640	0.00131	0.90556	-0.00048	0.00266	0.00008

3	0.02329	-0.02642	0.00166	0.89315	-0.00048	0.00266	0.00007
3	0.02795	-0.02645	0.00199	0.88074	-0.00048	0.00267	0.00007
3	0.03261	-0.02647	0.00232	0.86831	-0.00047	0.00267	0.00007
3	0.03727	-0.02650	0.00263	0.85587	-0.00047	0.00267	0.00007
3	0.04193	-0.02652	0.00294	0.84343	-0.00046	0.00267	0.00006
3	0.04658	-0.02655	0.00323	0.83098	-0.00046	0.00267	0.00006
3	0.05124	-0.02657	0.00352	0.81854	-0.00046	0.00267	0.00006
3	0.05590	-0.02660	0.00380	0.80609	-0.00045	0.00267	0.00006
3	0.06056	-0.02662	0.00407	0.79366	-0.00045	0.00267	0.00006
3	0.06522	-0.02665	0.00432	0.78123	-0.00045	0.00267	0.00005
3	0.06988	-0.02667	0.00457	0.76882	-0.00044	0.00266	0.00005
3	0.07454	-0.02670	0.00481	0.75642	-0.00044	0.00266	0.00005
3	0.07919	-0.02672	0.00504	0.74404	-0.00043	0.00266	0.00005
3	0.08385	-0.02675	0.00527	0.73169	-0.00043	0.00265	0.00005
3	0.08851	-0.02677	0.00548	0.71935	-0.00043	0.00264	0.00004
3	0.09317	-0.02680	0.00568	0.70705	-0.00042	0.00264	0.00004
3	0.09783	-0.02682	0.00588	0.69477	-0.00042	0.00263	0.00004
3	0.10249	-0.02685	0.00607	0.68253	-0.00041	0.00262	0.00004
3	0.10714	-0.02687	0.00624	0.67033	-0.00041	0.00262	0.00004
3	0.11180	-0.02690	0.00641	0.65816	-0.00041	0.00261	0.00004
4	0.00000	0.00271	0.00014	-0.01582	-0.00004	-0.00019	-0.00000
4	0.00417	0.00260	0.00014	-0.01502	-0.00004	-0.00020	-0.00000
4	0.00833	0.00248	0.00013	-0.01419	-0.00004	-0.00020	-0.00000
4	0.01250	0.00237	0.00013	-0.01333	-0.00004	-0.00021	-0.00000
4	0.01667	0.00226	0.00012	-0.01246	-0.00003	-0.00021	-0.00000
4	0.02083	0.00215	0.00011	-0.01158	-0.00003	-0.00021	-0.00000
4	0.02500	0.00203	0.00010	-0.01069	-0.00003	-0.00021	-0.00000
4	0.02917	0.00192	0.00010	-0.00980	-0.00003	-0.00021	-0.00000
4	0.03333	0.00181	0.00009	-0.00892	-0.00003	-0.00021	-0.00000
4	0.03750	0.00169	0.00008	-0.00805	-0.00003	-0.00021	-0.00000
4	0.04167	0.00158	0.00007	-0.00719	-0.00002	-0.00020	-0.00000
4	0.04583	0.00147	0.00007	-0.00635	-0.00002	-0.00020	-0.00000
4	0.05000	0.00136	0.00006	-0.00555	-0.00002	-0.00019	-0.00000
4	0.05417	0.00124	0.00005	-0.00477	-0.00002	-0.00018	-0.00000
4	0.05833	0.00113	0.00004	-0.00404	-0.00002	-0.00017	-0.00000
4	0.06250	0.00102	0.00004	-0.00334	-0.00002	-0.00016	-0.00000
4	0.06667	0.00090	0.00003	-0.00270	-0.00001	-0.00015	-0.00000
4	0.07083	0.00079	0.00002	-0.00211	-0.00001	-0.00013	-0.00000
4	0.07500	0.00068	0.00002	-0.00159	-0.00001	-0.00012	-0.00000
4	0.07917	0.00056	0.00001	-0.00112	-0.00001	-0.00010	-0.00000
4	0.08333	0.00045	0.00001	-0.00073	-0.00001	-0.00008	-0.00000
4	0.08750	0.00034	0.00000	-0.00042	-0.00001	-0.00007	-0.00000
4	0.09167	0.00023	0.00000	-0.00019	-0.00000	-0.00004	-0.00000
4	0.09583	0.00011	0.00000	-0.00005	-0.00000	-0.00002	-0.00000
4	0.10000	0.00000	0.00000	0.00000	0.00000	0.00000	0.00000
5	0.00000	-0.00144	-0.00058	0.01855	0.00000	0.00024	0.00001
5	0.00417	-0.00138	-0.00054	0.01752	0.00000	0.00025	0.00001
5	0.00833	-0.00132	-0.00049	0.01648	0.00000	0.00025	0.00001
5	0.01250	-0.00126	-0.00045	0.01542	0.00000	0.00025	0.00001
5	0.01667	-0.00120	-0.00041	0.01435	0.00000	0.00026	0.00001
5	0.02083	-0.00114	-0.00037	0.01329	0.00000	0.00026	0.00001
5	0.02500	-0.00108	-0.00033	0.01222	0.00000	0.00025	0.00001
5	0.02917	-0.00102	-0.00030	0.01117	0.00000	0.00025	0.00001
5	0.03333	-0.00096	-0.00026	0.01013	0.00000	0.00025	0.00001
5	0.03750	-0.00090	-0.00023	0.00911	0.00000	0.00024	0.00001
5	0.04167	-0.00084	-0.00020	0.00812	0.00000	0.00023	0.00001
5	0.04583	-0.00078	-0.00018	0.00715	0.00000	0.00023	0.00001
5	0.05000	-0.00072	-0.00015	0.00623	0.00000	0.00022	0.00001
5	0.05417	-0.00066	-0.00013	0.00534	0.00000	0.00021	0.00001
5	0.05833	-0.00060	-0.00010	0.00451	0.00000	0.00019	0.00000
5	0.06250	-0.00054	-0.00008	0.00373	0.00000	0.00018	0.00000
5	0.06667	-0.00048	-0.00007	0.00300	0.00000	0.00017	0.00000
5	0.07083	-0.00042	-0.00005	0.00234	0.00000	0.00015	0.00000
5	0.07500	-0.00036	-0.00004	0.00176	0.00000	0.00013	0.00000
5	0.07917	-0.00030	-0.00003	0.00124	0.00000	0.00011	0.00000
5	0.08333	-0.00024	-0.00002	0.00081	0.00000	0.00009	0.00000
5	0.08750	-0.00018	-0.00001	0.00046	0.00000	0.00007	0.00000
5	0.09167	-0.00012	-0.00000	0.00021	0.00000	0.00005	0.00000
5	0.09583	-0.00006	-0.00000	0.00005	0.00000	0.00003	0.00000
5	0.10000	0.00000	0.00000	0.00000	0.00000	0.00000	0.00000
6	0.00000	0.00000	0.00000	0.00000	0.00000	0.00000	0.00000
6	0.00417	0.00000	0.00000	0.00000	0.00000	0.00000	0.00000
6	0.00833	0.00000	0.00000	0.00000	0.00000	0.00000	0.00000
6	0.01250	0.00000	0.00000	0.00000	0.00000	0.00000	0.00000
6	0.01667	0.00000	0.00000	0.00000	0.00000	0.00000	0.00000
6	0.02083	0.00000	0.00000	0.00000	0.00000	0.00000	0.00000
6	0.02500	0.00000	0.00000	0.00000	0.00000	0.00000	0.00000
6	0.02917	0.00000	0.00000	0.00000	0.00000	0.00000	0.00000
6	0.03333	0.00000	0.00000	0.00000	0.00000	0.00000	0.00000
6	0.03750	0.00000	0.00000	0.00000	0.00000	0.00000	0.00000

6	0.04167	0.00000	0.00000	0.00000	0.00000	0.00000	0.00000
6	0.04583	0.00000	0.00000	0.00000	0.00000	0.00000	0.00000
6	0.05000	0.00000	0.00000	0.00000	0.00000	0.00000	0.00000
6	0.05417	0.00000	0.00000	0.00000	0.00000	0.00000	0.00000
6	0.05833	0.00000	0.00000	0.00000	0.00000	0.00000	0.00000
6	0.06250	0.00000	0.00000	0.00000	0.00000	0.00000	0.00000
6	0.06667	0.00000	0.00000	0.00000	0.00000	0.00000	0.00000
6	0.07083	0.00000	0.00000	0.00000	0.00000	0.00000	0.00000
6	0.07500	0.00000	0.00000	0.00000	0.00000	0.00000	0.00000
6	0.07917	0.00000	0.00000	0.00000	0.00000	0.00000	0.00000
6	0.08333	0.00000	0.00000	0.00000	0.00000	0.00000	0.00000
6	0.08750	0.00000	0.00000	0.00000	0.00000	0.00000	0.00000
6	0.09167	0.00000	0.00000	0.00000	0.00000	0.00000	0.00000
6	0.09583	0.00000	0.00000	0.00000	0.00000	0.00000	0.00000
6	0.10000	0.00000	0.00000	0.00000	0.00000	0.00000	0.00000
7	0.00000	0.00017	-0.74684	-0.42096	-0.00264	0.00015	-0.00048
7	0.03333	0.00017	-0.76269	-0.42590	-0.00264	0.00015	-0.00048
7	0.06667	0.00017	-0.77855	-0.43084	-0.00264	0.00015	-0.00048
7	0.10000	0.00017	-0.79442	-0.43578	-0.00264	0.00015	-0.00048
7	0.13333	0.00017	-0.81033	-0.44072	-0.00264	0.00015	-0.00048
7	0.16667	0.00017	-0.82631	-0.44565	-0.00264	0.00015	-0.00048
7	0.20000	0.00017	-0.84239	-0.45059	-0.00264	0.00015	-0.00048
7	0.25000	0.00015	-0.86713	-0.45738	-0.00256	0.00012	-0.00050
7	0.30000	0.00012	-0.89163	-0.46294	-0.00249	0.00010	-0.00047
7	0.35000	0.00009	-0.91393	-0.46726	-0.00241	0.00007	-0.00041
7	0.40000	0.00006	-0.93214	-0.47035	-0.00234	0.00005	-0.00031
7	0.45000	0.00003	-0.94440	-0.47220	-0.00226	0.00002	-0.00017
7	0.50000	0.00000	-0.94889	-0.47282	-0.00219	0.00000	-0.00000
7	0.55000	-0.00003	-0.94440	-0.47220	-0.00226	-0.00002	0.00017
7	0.60000	-0.00006	-0.93214	-0.47035	-0.00234	-0.00005	0.00031
7	0.65000	-0.00009	-0.91393	-0.46726	-0.00241	-0.00007	0.00041
7	0.70000	-0.00012	-0.89163	-0.46294	-0.00249	-0.00010	0.00047
7	0.75000	-0.00015	-0.86713	-0.45738	-0.00256	-0.00012	0.00050
7	0.80000	-0.00017	-0.84239	-0.45059	-0.00264	-0.00015	0.00048
7	0.83333	-0.00017	-0.82631	-0.44565	-0.00264	-0.00015	0.00048
7	0.86667	-0.00017	-0.81033	-0.44072	-0.00264	-0.00015	0.00048
7	0.90000	-0.00017	-0.79442	-0.43578	-0.00264	-0.00015	0.00048
7	0.93333	-0.00017	-0.77855	-0.43084	-0.00264	-0.00015	0.00048
7	0.96667	-0.00017	-0.76269	-0.42590	-0.00264	-0.00015	0.00048
7	1.00000	-0.00017	-0.74684	-0.42096	-0.00264	-0.00015	0.00048
8	0.00000	-0.02690	0.00641	0.65816	-0.00041	0.00261	0.00004
8	0.00932	-0.02695	0.00673	0.63396	-0.00040	0.00259	0.00003
8	0.01863	-0.02700	0.00701	0.60995	-0.00039	0.00257	0.00003
8	0.02795	-0.02705	0.00726	0.58617	-0.00038	0.00254	0.00003
8	0.03727	-0.02710	0.00748	0.56262	-0.00038	0.00251	0.00002
8	0.04658	-0.02715	0.00766	0.53934	-0.00037	0.00248	0.00002
8	0.05590	-0.02720	0.00782	0.51635	-0.00036	0.00245	0.00002
8	0.06522	-0.02725	0.00795	0.49368	-0.00035	0.00242	0.00001
8	0.07454	-0.02730	0.00804	0.47134	-0.00035	0.00238	0.00001
8	0.08385	-0.02735	0.00811	0.44936	-0.00034	0.00234	0.00001
8	0.09317	-0.02740	0.00816	0.42778	-0.00033	0.00230	0.00000
8	0.10249	-0.02745	0.00817	0.40660	-0.00032	0.00225	0.00000
8	0.11180	-0.02750	0.00816	0.38586	-0.00031	0.00220	-0.00000
8	0.12112	-0.02755	0.00812	0.36557	-0.00031	0.00215	-0.00001
8	0.13044	-0.02760	0.00806	0.34577	-0.00030	0.00210	-0.00001
8	0.13975	-0.02765	0.00798	0.32648	-0.00029	0.00204	-0.00001
8	0.14907	-0.02770	0.00787	0.30772	-0.00028	0.00198	-0.00001
8	0.15839	-0.02775	0.00774	0.28951	-0.00028	0.00192	-0.00002
8	0.16771	-0.02781	0.00758	0.27188	-0.00027	0.00186	-0.00002
8	0.17702	-0.02786	0.00741	0.25486	-0.00026	0.00179	-0.00002
8	0.18634	-0.02791	0.00721	0.23846	-0.00025	0.00173	-0.00002
8	0.19566	-0.02796	0.00699	0.22271	-0.00025	0.00165	-0.00002
8	0.20497	-0.02801	0.00676	0.20765	-0.00024	0.00158	-0.00003
8	0.21429	-0.02806	0.00650	0.19328	-0.00023	0.00150	-0.00003
8	0.22361	-0.02811	0.00623	0.17963	-0.00022	0.00142	-0.00003
9	0.00000	0.02953	0.00843	0.10151	-0.00017	0.00076	0.00002
9	0.01768	0.02885	0.00875	0.08855	-0.00017	0.00071	0.00002
9	0.03536	0.02816	0.00898	0.07637	-0.00016	0.00067	0.00001
9	0.05303	0.02748	0.00911	0.06498	-0.00016	0.00062	0.00000
9	0.07071	0.02680	0.00915	0.05435	-0.00015	0.00058	-0.00000
9	0.08839	0.02611	0.00911	0.04449	-0.00014	0.00054	-0.00000
9	0.10607	0.02543	0.00899	0.03538	-0.00014	0.00049	-0.00001
9	0.12374	0.02474	0.00880	0.02702	-0.00013	0.00045	-0.00001
9	0.14142	0.02406	0.00854	0.01939	-0.00013	0.00041	-0.00002
9	0.15910	0.02338	0.00822	0.01249	-0.00012	0.00037	-0.00002
9	0.17678	0.02269	0.00785	0.00630	-0.00011	0.00033	-0.00002
9	0.19445	0.02201	0.00743	0.00083	-0.00011	0.00029	-0.00003
9	0.21213	0.02132	0.00696	-0.00394	-0.00010	0.00025	-0.00003
9	0.22981	0.02064	0.00646	-0.00801	-0.00009	0.00021	-0.00003
9	0.24749	0.01995	0.00593	-0.01140	-0.00009	0.00017	-0.00003

9	0.26517	0.01927	0.00537	-0.01411	-0.00008	0.00013	-0.00003
9	0.28284	0.01859	0.00479	-0.01615	-0.00008	0.00010	-0.00003
9	0.30052	0.01790	0.00420	-0.01753	-0.00007	0.00006	-0.00003
9	0.31820	0.01722	0.00360	-0.01825	-0.00006	0.00002	-0.00003
9	0.33588	0.01653	0.00300	-0.01832	-0.00006	-0.00001	-0.00003
9	0.35355	0.01585	0.00240	-0.01776	-0.00005	-0.00005	-0.00003
9	0.37123	0.01516	0.00180	-0.01657	-0.00005	-0.00009	-0.00003
9	0.38891	0.01448	0.00123	-0.01475	-0.00004	-0.00012	-0.00003
9	0.40659	0.01379	0.00067	-0.01232	-0.00003	-0.00015	-0.00003
9	0.42426	0.01311	0.00014	-0.00927	-0.00003	-0.00019	-0.00003
11	0.00000	-0.42096	-0.74684	-0.00017	-0.00048	0.00015	0.00264
11	0.00208	-0.42096	-0.74134	-0.00048	-0.00048	0.00015	0.00264
11	0.00417	-0.42096	-0.73584	-0.00079	-0.00048	0.00015	0.00264
11	0.00625	-0.42096	-0.73034	-0.00110	-0.00048	0.00015	0.00264
11	0.00833	-0.42096	-0.72484	-0.00141	-0.00048	0.00015	0.00264
11	0.01042	-0.42096	-0.71934	-0.00172	-0.00048	0.00015	0.00264
11	0.01250	-0.42096	-0.71384	-0.00203	-0.00048	0.00015	0.00264
11	0.01458	-0.42096	-0.70834	-0.00234	-0.00048	0.00015	0.00264
11	0.01667	-0.42096	-0.70284	-0.00264	-0.00048	0.00015	0.00264
11	0.01875	-0.42096	-0.69734	-0.00295	-0.00048	0.00015	0.00264
11	0.02083	-0.42096	-0.69183	-0.00326	-0.00048	0.00015	0.00264
11	0.02292	-0.42096	-0.68633	-0.00357	-0.00048	0.00015	0.00264
11	0.02500	-0.42096	-0.68083	-0.00388	-0.00048	0.00015	0.00264
11	0.02708	-0.42096	-0.67533	-0.00419	-0.00048	0.00015	0.00264
11	0.02917	-0.42096	-0.66983	-0.00450	-0.00048	0.00015	0.00264
11	0.03125	-0.42096	-0.66433	-0.00480	-0.00048	0.00015	0.00264
11	0.03333	-0.42096	-0.65883	-0.00511	-0.00048	0.00015	0.00264
11	0.03542	-0.42096	-0.65333	-0.00542	-0.00048	0.00015	0.00264
11	0.03750	-0.42096	-0.64783	-0.00573	-0.00048	0.00015	0.00264
11	0.03958	-0.42096	-0.64233	-0.00604	-0.00048	0.00015	0.00264
11	0.04167	-0.42096	-0.63683	-0.00635	-0.00048	0.00015	0.00264
11	0.04375	-0.42096	-0.63133	-0.00666	-0.00048	0.00015	0.00264
11	0.04583	-0.42096	-0.62583	-0.00697	-0.00048	0.00015	0.00264
11	0.04792	-0.42096	-0.62032	-0.00727	-0.00048	0.00015	0.00264
11	0.05000	-0.42096	-0.61482	-0.00758	-0.00048	0.00015	0.00264
12	0.00000	-0.10151	0.00843	0.02953	-0.00002	0.00076	-0.00017
12	0.00295	-0.10148	0.00792	0.02734	-0.00002	0.00073	-0.00017
12	0.00589	-0.10146	0.00740	0.02521	-0.00002	0.00071	-0.00017
12	0.00884	-0.10143	0.00689	0.02314	-0.00002	0.00069	-0.00017
12	0.01179	-0.10140	0.00638	0.02114	-0.00002	0.00067	-0.00017
12	0.01473	-0.10138	0.00588	0.01919	-0.00002	0.00065	-0.00017
12	0.01768	-0.10135	0.00537	0.01730	-0.00002	0.00063	-0.00017
12	0.02062	-0.10132	0.00486	0.01547	-0.00003	0.00061	-0.00017
12	0.02357	-0.10129	0.00436	0.01369	-0.00003	0.00060	-0.00017
12	0.02652	-0.10127	0.00386	0.01195	-0.00003	0.00058	-0.00017
12	0.02946	-0.10124	0.00335	0.01027	-0.00003	0.00056	-0.00017
12	0.03241	-0.10121	0.00285	0.00863	-0.00003	0.00055	-0.00017
12	0.03536	-0.10119	0.00235	0.00704	-0.00003	0.00053	-0.00017
12	0.03830	-0.10116	0.00186	0.00549	-0.00003	0.00052	-0.00017
12	0.04125	-0.10113	0.00136	0.00398	-0.00003	0.00051	-0.00017
12	0.04419	-0.10110	0.00086	0.00250	-0.00003	0.00049	-0.00017
12	0.04714	-0.10108	0.00037	0.00106	-0.00003	0.00048	-0.00017
12	0.05009	-0.10105	-0.00013	-0.00034	-0.00003	0.00047	-0.00017
12	0.05303	-0.10102	-0.00062	-0.00172	-0.00003	0.00046	-0.00017
12	0.05598	-0.10100	-0.00111	-0.00306	-0.00003	0.00045	-0.00017
12	0.05893	-0.10097	-0.00160	-0.00438	-0.00003	0.00044	-0.00017
12	0.06187	-0.10094	-0.00209	-0.00567	-0.00003	0.00043	-0.00017
12	0.06482	-0.10091	-0.00258	-0.00694	-0.00003	0.00043	-0.00017
12	0.06776	-0.10089	-0.00307	-0.00819	-0.00003	0.00042	-0.00017
12	0.07071	-0.10086	-0.00355	-0.00942	-0.00003	0.00041	-0.00016
13	0.00000	-0.04332	-0.00355	0.09157	-0.00017	0.00041	-0.00002
13	0.03449	-0.04224	-0.00430	0.07837	-0.00016	0.00035	-0.00002
13	0.06897	-0.04116	-0.00490	0.06725	-0.00015	0.00029	-0.00002
13	0.10346	-0.04008	-0.00538	0.05805	-0.00015	0.00024	-0.00001
13	0.13794	-0.03900	-0.00573	0.05057	-0.00014	0.00019	-0.00001
13	0.17243	-0.03792	-0.00597	0.04466	-0.00013	0.00015	-0.00001
13	0.20691	-0.03683	-0.00611	0.04013	-0.00013	0.00011	-0.00000
13	0.24140	-0.03575	-0.00615	0.03681	-0.00012	0.00008	0.00000
13	0.27588	-0.03467	-0.00610	0.03454	-0.00011	0.00005	0.00000
13	0.31037	-0.03359	-0.00597	0.03314	-0.00011	0.00003	0.00000
13	0.34485	-0.03251	-0.00577	0.03246	-0.00010	0.00001	0.00001
13	0.37934	-0.03143	-0.00551	0.03231	-0.00009	-0.00000	0.00001
13	0.41382	-0.03035	-0.00520	0.03254	-0.00009	-0.00001	0.00001
13	0.44831	-0.02927	-0.00485	0.03298	-0.00008	-0.00001	0.00001
13	0.48279	-0.02820	-0.00446	0.03347	-0.00007	-0.00001	0.00001
13	0.51728	-0.02712	-0.00405	0.03385	-0.00007	-0.00001	0.00001
13	0.55176	-0.02604	-0.00361	0.03397	-0.00006	0.00000	0.00001
13	0.58625	-0.02496	-0.00317	0.03366	-0.00006	0.00002	0.00001
13	0.62074	-0.02388	-0.00273	0.03276	-0.00005	0.00004	0.00001

13	0.65522	-0.02280	-0.00230	0.03113	-0.00004	0.00006	0.00001
13	0.68971	-0.02173	-0.00189	0.02860	-0.00004	0.00009	0.00001
13	0.72419	-0.02065	-0.00150	0.02503	-0.00003	0.00012	0.00001
13	0.75868	-0.01957	-0.00115	0.02026	-0.00002	0.00016	0.00001
13	0.79316	-0.01849	-0.00084	0.01415	-0.00002	0.00020	0.00001
13	0.82765	-0.01742	-0.00058	0.00654	-0.00001	0.00024	0.00001
14	0.00000	0.00000	0.00000	0.00000	0.00000	0.00000	0.00000
14	0.04167	0.00000	-0.00000	0.00002	0.00000	-0.00000	-0.00000
14	0.08333	0.00000	-0.00000	0.00005	0.00000	-0.00000	-0.00000
14	0.12500	0.00000	-0.00000	0.00010	0.00000	-0.00000	-0.00000
14	0.16667	0.00000	-0.00000	0.00014	0.00000	-0.00000	-0.00000
14	0.20833	0.00000	-0.00000	0.00016	0.00000	-0.00000	-0.00000
14	0.25000	0.00000	-0.00000	0.00017	0.00000	0.00000	0.00000
14	0.29167	0.00000	-0.00000	0.00016	0.00000	0.00000	0.00000
14	0.33333	0.00000	-0.00000	0.00014	0.00000	0.00000	0.00000
14	0.37500	0.00000	-0.00000	0.00010	0.00000	0.00000	0.00000
14	0.41667	0.00000	-0.00000	0.00005	0.00000	0.00000	0.00000
14	0.45833	0.00000	-0.00000	0.00002	0.00000	0.00000	0.00000
14	0.50000	0.00000	0.00000	0.00000	0.00000	0.00000	0.00000
14	0.51042	0.00000	-0.00000	0.00000	0.00000	-0.00000	-0.00000
14	0.52083	0.00000	-0.00000	0.00000	0.00000	-0.00000	-0.00000
14	0.53125	0.00000	-0.00000	0.00000	0.00000	-0.00000	-0.00000
14	0.54167	0.00000	-0.00000	0.00000	0.00000	-0.00000	-0.00000
14	0.55208	0.00000	-0.00000	0.00000	0.00000	-0.00000	-0.00000
14	0.56250	0.00000	-0.00000	0.00000	0.00000	0.00000	0.00000
14	0.57292	0.00000	-0.00000	0.00000	0.00000	0.00000	0.00000
14	0.58333	0.00000	-0.00000	0.00000	0.00000	0.00000	0.00000
14	0.59375	0.00000	-0.00000	0.00000	0.00000	0.00000	0.00000
14	0.60417	0.00000	-0.00000	0.00000	0.00000	0.00000	0.00000
14	0.61458	0.00000	-0.00000	0.00000	0.00000	0.00000	0.00000
14	0.62500	0.00000	0.00000	0.00000	0.00000	0.00000	0.00000
15	0.00000	0.03014	-0.00623	0.17930	0.00022	0.00142	-0.00004
15	0.00295	0.03011	-0.00635	0.17514	0.00022	0.00140	-0.00004
15	0.00589	0.03009	-0.00647	0.17106	0.00022	0.00137	-0.00004
15	0.00884	0.03006	-0.00658	0.16705	0.00021	0.00135	-0.00004
15	0.01179	0.03004	-0.00670	0.16312	0.00021	0.00132	-0.00004
15	0.01473	0.03001	-0.00681	0.15926	0.00021	0.00130	-0.00004
15	0.01768	0.02999	-0.00691	0.15549	0.00021	0.00127	-0.00004
15	0.02062	0.02996	-0.00702	0.15179	0.00021	0.00124	-0.00004
15	0.02357	0.02994	-0.00712	0.14817	0.00020	0.00121	-0.00003
15	0.02652	0.02991	-0.00722	0.14463	0.00020	0.00119	-0.00003
15	0.02946	0.02989	-0.00732	0.14117	0.00020	0.00116	-0.00003
15	0.03241	0.02986	-0.00741	0.13779	0.00020	0.00113	-0.00003
15	0.03536	0.02983	-0.00751	0.13449	0.00020	0.00111	-0.00003
15	0.03830	0.02981	-0.00760	0.13128	0.00020	0.00108	-0.00003
15	0.04125	0.02978	-0.00768	0.12815	0.00019	0.00105	-0.00003
15	0.04419	0.02976	-0.00777	0.12510	0.00019	0.00102	-0.00003
15	0.04714	0.02973	-0.00785	0.12213	0.00019	0.00099	-0.00003
15	0.05009	0.02971	-0.00793	0.11925	0.00019	0.00096	-0.00003
15	0.05303	0.02968	-0.00801	0.11646	0.00019	0.00093	-0.00003
15	0.05598	0.02966	-0.00808	0.11375	0.00018	0.00090	-0.00003
15	0.05893	0.02963	-0.00816	0.11113	0.00018	0.00088	-0.00002
15	0.06187	0.02961	-0.00823	0.10859	0.00018	0.00085	-0.00002
15	0.06482	0.02958	-0.00830	0.10614	0.00018	0.00082	-0.00002
15	0.06776	0.02956	-0.00836	0.10378	0.00018	0.00079	-0.00002
15	0.07071	0.02953	-0.00843	0.10151	0.00017	0.00076	-0.00002
16	0.00000	-0.02630	0.00017	0.95497	0.00050	0.00264	-0.00008
16	0.00466	-0.02632	-0.00021	0.94265	0.00050	0.00265	-0.00008
16	0.00932	-0.02635	-0.00059	0.93031	0.00049	0.00265	-0.00008
16	0.01398	-0.02637	-0.00095	0.91794	0.00049	0.00266	-0.00008
16	0.01863	-0.02640	-0.00131	0.90556	0.00048	0.00266	-0.00008
16	0.02329	-0.02642	-0.00166	0.89315	0.00048	0.00266	-0.00007
16	0.02795	-0.02645	-0.00199	0.88074	0.00048	0.00267	-0.00007
16	0.03261	-0.02647	-0.00232	0.86831	0.00047	0.00267	-0.00007
16	0.03727	-0.02650	-0.00263	0.85587	0.00047	0.00267	-0.00007
16	0.04193	-0.02652	-0.00294	0.84343	0.00046	0.00267	-0.00006
16	0.04658	-0.02655	-0.00323	0.83098	0.00046	0.00267	-0.00006
16	0.05124	-0.02657	-0.00352	0.81854	0.00046	0.00267	-0.00006
16	0.05590	-0.02660	-0.00380	0.80609	0.00045	0.00267	-0.00006
16	0.06056	-0.02662	-0.00407	0.79366	0.00045	0.00267	-0.00006
16	0.06522	-0.02665	-0.00432	0.78123	0.00045	0.00267	-0.00005
16	0.06988	-0.02667	-0.00457	0.76882	0.00044	0.00266	-0.00005
16	0.07454	-0.02670	-0.00481	0.75642	0.00044	0.00266	-0.00005
16	0.07919	-0.02672	-0.00504	0.74404	0.00043	0.00266	-0.00005
16	0.08385	-0.02675	-0.00527	0.73169	0.00043	0.00265	-0.00005
16	0.08851	-0.02677	-0.00548	0.71935	0.00043	0.00264	-0.00004
16	0.09317	-0.02680	-0.00568	0.70705	0.00042	0.00264	-0.00004
16	0.09783	-0.02682	-0.00588	0.69477	0.00042	0.00263	-0.00004
16	0.10249	-0.02685	-0.00607	0.68253	0.00041	0.00262	-0.00004

16	0.10714	-0.02687	-0.00624	0.67033	0.00041	0.00262	-0.00004
16	0.11180	-0.02690	-0.00641	0.65816	0.00041	0.00261	-0.00004
17	0.00000	0.00271	-0.00014	-0.01582	0.00004	-0.00019	0.00000
17	0.00417	0.00260	-0.00014	-0.01502	0.00004	-0.00020	0.00000
17	0.00833	0.00248	-0.00013	-0.01419	0.00004	-0.00020	0.00000
17	0.01250	0.00237	-0.00013	-0.01333	0.00004	-0.00021	0.00000
17	0.01667	0.00226	-0.00012	-0.01246	0.00003	-0.00021	0.00000
17	0.02083	0.00215	-0.00011	-0.01158	0.00003	-0.00021	0.00000
17	0.02500	0.00203	-0.00010	-0.01069	0.00003	-0.00021	0.00000
17	0.02917	0.00192	-0.00010	-0.00980	0.00003	-0.00021	0.00000
17	0.03333	0.00181	-0.00009	-0.00892	0.00003	-0.00021	0.00000
17	0.03750	0.00169	-0.00008	-0.00805	0.00003	-0.00021	0.00000
17	0.04167	0.00158	-0.00007	-0.00719	0.00002	-0.00020	0.00000
17	0.04583	0.00147	-0.00007	-0.00635	0.00002	-0.00020	0.00000
17	0.05000	0.00136	-0.00006	-0.00555	0.00002	-0.00019	0.00000
17	0.05417	0.00124	-0.00005	-0.00477	0.00002	-0.00018	0.00000
17	0.05833	0.00113	-0.00004	-0.00404	0.00002	-0.00017	0.00000
17	0.06250	0.00102	-0.00004	-0.00334	0.00002	-0.00016	0.00000
17	0.06667	0.00090	-0.00003	-0.00270	0.00001	-0.00015	0.00000
17	0.07083	0.00079	-0.00002	-0.00211	0.00001	-0.00013	0.00000
17	0.07500	0.00068	-0.00002	-0.00159	0.00001	-0.00012	0.00000
17	0.07917	0.00056	-0.00001	-0.00112	0.00001	-0.00010	0.00000
17	0.08333	0.00045	-0.00001	-0.00073	0.00001	-0.00008	0.00000
17	0.08750	0.00034	-0.00000	-0.00042	0.00001	-0.00007	0.00000
17	0.09167	0.00023	-0.00000	-0.00019	0.00000	-0.00004	0.00000
17	0.09583	0.00011	-0.00000	-0.00005	0.00000	-0.00002	0.00000
17	0.10000	0.00000	0.00000	0.00000	0.00000	0.00000	0.00000
18	0.00000	-0.00144	0.00058	0.01855	-0.00000	0.00024	-0.00001
18	0.00417	-0.00138	0.00054	0.01752	-0.00000	0.00025	-0.00001
18	0.00833	-0.00132	0.00049	0.01648	-0.00000	0.00025	-0.00001
18	0.01250	-0.00126	0.00045	0.01542	-0.00000	0.00025	-0.00001
18	0.01667	-0.00120	0.00041	0.01435	-0.00000	0.00026	-0.00001
18	0.02083	-0.00114	0.00037	0.01329	-0.00000	0.00026	-0.00001
18	0.02500	-0.00108	0.00033	0.01222	-0.00000	0.00025	-0.00001
18	0.02917	-0.00102	0.00030	0.01117	-0.00000	0.00025	-0.00001
18	0.03333	-0.00096	0.00026	0.01013	-0.00000	0.00025	-0.00001
18	0.03750	-0.00090	0.00023	0.00911	-0.00000	0.00024	-0.00001
18	0.04167	-0.00084	0.00020	0.00812	-0.00000	0.00023	-0.00001
18	0.04583	-0.00078	0.00018	0.00715	-0.00000	0.00023	-0.00001
18	0.05000	-0.00072	0.00015	0.00623	-0.00000	0.00022	-0.00001
18	0.05417	-0.00066	0.00013	0.00534	-0.00000	0.00021	-0.00001
18	0.05833	-0.00060	0.00010	0.00451	-0.00000	0.00019	-0.00000
18	0.06250	-0.00054	0.00008	0.00373	-0.00000	0.00018	-0.00000
18	0.06667	-0.00048	0.00007	0.00300	-0.00000	0.00017	-0.00000
18	0.07083	-0.00042	0.00005	0.00234	-0.00000	0.00015	-0.00000
18	0.07500	-0.00036	0.00004	0.00176	-0.00000	0.00013	-0.00000
18	0.07917	-0.00030	0.00003	0.00124	-0.00000	0.00011	-0.00000
18	0.08333	-0.00024	0.00002	0.00081	-0.00000	0.00009	-0.00000
18	0.08750	-0.00018	0.00001	0.00046	-0.00000	0.00007	-0.00000
18	0.09167	-0.00012	0.00000	0.00021	-0.00000	0.00005	-0.00000
18	0.09583	-0.00006	0.00000	0.00005	-0.00000	0.00003	-0.00000
18	0.10000	0.00000	0.00000	0.00000	0.00000	0.00000	0.00000
19	0.00000	0.00000	0.00000	0.00000	0.00000	0.00000	0.00000
19	0.00417	0.00000	0.00000	0.00000	0.00000	0.00000	0.00000
19	0.00833	0.00000	0.00000	0.00000	0.00000	0.00000	0.00000
19	0.01250	0.00000	0.00000	0.00000	0.00000	0.00000	0.00000
19	0.01667	0.00000	0.00000	0.00000	0.00000	0.00000	0.00000
19	0.02083	0.00000	0.00000	0.00000	0.00000	0.00000	0.00000
19	0.02500	0.00000	0.00000	0.00000	0.00000	0.00000	0.00000
19	0.02917	0.00000	0.00000	0.00000	0.00000	0.00000	0.00000
19	0.03333	0.00000	0.00000	0.00000	0.00000	0.00000	0.00000
19	0.03750	0.00000	0.00000	0.00000	0.00000	0.00000	0.00000
19	0.04167	0.00000	0.00000	0.00000	0.00000	0.00000	0.00000
19	0.04583	0.00000	0.00000	0.00000	0.00000	0.00000	0.00000
19	0.05000	0.00000	0.00000	0.00000	0.00000	0.00000	0.00000
19	0.05417	0.00000	0.00000	0.00000	0.00000	0.00000	0.00000
19	0.05833	0.00000	0.00000	0.00000	0.00000	0.00000	0.00000
19	0.06250	0.00000	0.00000	0.00000	0.00000	0.00000	0.00000
19	0.06667	0.00000	0.00000	0.00000	0.00000	0.00000	0.00000
19	0.07083	0.00000	0.00000	0.00000	0.00000	0.00000	0.00000
19	0.07500	0.00000	0.00000	0.00000	0.00000	0.00000	0.00000
19	0.07917	0.00000	0.00000	0.00000	0.00000	0.00000	0.00000
19	0.08333	0.00000	0.00000	0.00000	0.00000	0.00000	0.00000
19	0.08750	0.00000	0.00000	0.00000	0.00000	0.00000	0.00000
19	0.09167	0.00000	0.00000	0.00000	0.00000	0.00000	0.00000
19	0.09583	0.00000	0.00000	0.00000	0.00000	0.00000	0.00000
19	0.10000	0.00000	0.00000	0.00000	0.00000	0.00000	0.00000
21	0.00000	-0.02690	-0.00641	0.65816	0.00041	0.00261	-0.00004
21	0.00932	-0.02695	-0.00673	0.63396	0.00040	0.00259	-0.00003

21	0.01863	-0.02700	-0.00701	0.60995	0.00039	0.00257	-0.00003
21	0.02795	-0.02705	-0.00726	0.58617	0.00038	0.00254	-0.00003
21	0.03727	-0.02710	-0.00748	0.56262	0.00038	0.00251	-0.00002
21	0.04658	-0.02715	-0.00766	0.53934	0.00037	0.00248	-0.00002
21	0.05590	-0.02720	-0.00782	0.51635	0.00036	0.00245	-0.00002
21	0.06522	-0.02725	-0.00795	0.49368	0.00035	0.00242	-0.00001
21	0.07454	-0.02730	-0.00804	0.47134	0.00035	0.00238	-0.00001
21	0.08385	-0.02735	-0.00811	0.44936	0.00034	0.00234	-0.00001
21	0.09317	-0.02740	-0.00816	0.42778	0.00033	0.00230	-0.00000
21	0.10249	-0.02745	-0.00817	0.40660	0.00032	0.00225	-0.00000
21	0.11180	-0.02750	-0.00816	0.38586	0.00031	0.00220	0.00000
21	0.12112	-0.02755	-0.00812	0.36557	0.00031	0.00215	0.00001
21	0.13044	-0.02760	-0.00806	0.34577	0.00030	0.00210	0.00001
21	0.13975	-0.02765	-0.00798	0.32648	0.00029	0.00204	0.00001
21	0.14907	-0.02770	-0.00787	0.30772	0.00028	0.00198	0.00001
21	0.15839	-0.02775	-0.00774	0.28951	0.00028	0.00192	0.00002
21	0.16771	-0.02781	-0.00758	0.27188	0.00027	0.00186	0.00002
21	0.17702	-0.02786	-0.00741	0.25486	0.00026	0.00179	0.00002
21	0.18634	-0.02791	-0.00721	0.23846	0.00025	0.00173	0.00002
21	0.19566	-0.02796	-0.00699	0.22271	0.00025	0.00165	0.00002
21	0.20497	-0.02801	-0.00676	0.20765	0.00024	0.00158	0.00003
21	0.21429	-0.02806	-0.00650	0.19328	0.00023	0.00150	0.00003
21	0.22361	-0.02811	-0.00623	0.17963	0.00022	0.00142	0.00003
22	0.00000	0.02953	-0.00843	0.10151	0.00017	0.00076	-0.00002
22	0.01768	0.02885	-0.00875	0.08855	0.00017	0.00071	-0.00002
22	0.03536	0.02816	-0.00898	0.07637	0.00016	0.00067	-0.00001
22	0.05303	0.02748	-0.00911	0.06498	0.00016	0.00062	-0.00000
22	0.07071	0.02680	-0.00915	0.05435	0.00015	0.00058	0.00000
22	0.08839	0.02611	-0.00911	0.04449	0.00014	0.00054	0.00000
22	0.10607	0.02543	-0.00899	0.03538	0.00014	0.00049	0.00001
22	0.12374	0.02474	-0.00880	0.02702	0.00013	0.00045	0.00001
22	0.14142	0.02406	-0.00854	0.01939	0.00013	0.00041	0.00002
22	0.15910	0.02338	-0.00822	0.01249	0.00012	0.00037	0.00002
22	0.17678	0.02269	-0.00785	0.00630	0.00011	0.00033	0.00002
22	0.19445	0.02201	-0.00743	0.00083	0.00011	0.00029	0.00003
22	0.21213	0.02132	-0.00696	-0.00394	0.00010	0.00025	0.00003
22	0.22981	0.02064	-0.00646	-0.00801	0.00009	0.00021	0.00003
22	0.24749	0.01995	-0.00593	-0.01140	0.00009	0.00017	0.00003
22	0.26517	0.01927	-0.00537	-0.01411	0.00008	0.00013	0.00003
22	0.28284	0.01859	-0.00479	-0.01615	0.00008	0.00010	0.00003
22	0.30052	0.01790	-0.00420	-0.01753	0.00007	0.00006	0.00003
22	0.31820	0.01722	-0.00360	-0.01825	0.00006	0.00002	0.00003
22	0.33588	0.01653	-0.00300	-0.01832	0.00006	-0.00001	0.00003
22	0.35355	0.01585	-0.00240	-0.01776	0.00005	-0.00005	0.00003
22	0.37123	0.01516	-0.00180	-0.01657	0.00005	-0.00009	0.00003
22	0.38891	0.01448	-0.00123	-0.01475	0.00004	-0.00012	0.00003
22	0.40659	0.01379	-0.00067	-0.01232	0.00003	-0.00015	0.00003
22	0.42426	0.01311	-0.00014	-0.00927	0.00003	-0.00019	0.00003
23	0.00000	-0.42096	-0.74684	0.00017	0.00048	-0.00015	0.00264
23	0.00208	-0.42096	-0.74134	0.00048	0.00048	-0.00015	0.00264
23	0.00417	-0.42096	-0.73584	0.00079	0.00048	-0.00015	0.00264
23	0.00625	-0.42096	-0.73034	0.00110	0.00048	-0.00015	0.00264
23	0.00833	-0.42096	-0.72484	0.00141	0.00048	-0.00015	0.00264
23	0.01042	-0.42096	-0.71934	0.00172	0.00048	-0.00015	0.00264
23	0.01250	-0.42096	-0.71384	0.00203	0.00048	-0.00015	0.00264
23	0.01458	-0.42096	-0.70834	0.00234	0.00048	-0.00015	0.00264
23	0.01667	-0.42096	-0.70284	0.00264	0.00048	-0.00015	0.00264
23	0.01875	-0.42096	-0.69734	0.00295	0.00048	-0.00015	0.00264
23	0.02083	-0.42096	-0.69183	0.00326	0.00048	-0.00015	0.00264
23	0.02292	-0.42096	-0.68633	0.00357	0.00048	-0.00015	0.00264
23	0.02500	-0.42096	-0.68083	0.00388	0.00048	-0.00015	0.00264
23	0.02708	-0.42096	-0.67533	0.00419	0.00048	-0.00015	0.00264
23	0.02917	-0.42096	-0.66983	0.00450	0.00048	-0.00015	0.00264
23	0.03125	-0.42096	-0.66433	0.00480	0.00048	-0.00015	0.00264
23	0.03333	-0.42096	-0.65883	0.00511	0.00048	-0.00015	0.00264
23	0.03542	-0.42096	-0.65333	0.00542	0.00048	-0.00015	0.00264
23	0.03750	-0.42096	-0.64783	0.00573	0.00048	-0.00015	0.00264
23	0.03958	-0.42096	-0.64233	0.00604	0.00048	-0.00015	0.00264
23	0.04167	-0.42096	-0.63683	0.00635	0.00048	-0.00015	0.00264
23	0.04375	-0.42096	-0.63133	0.00666	0.00048	-0.00015	0.00264
23	0.04583	-0.42096	-0.62583	0.00697	0.00048	-0.00015	0.00264
23	0.04792	-0.42096	-0.62032	0.00727	0.00048	-0.00015	0.00264
23	0.05000	-0.42096	-0.61482	0.00758	0.00048	-0.00015	0.00264
24	0.00000	-0.47282	-0.94889	-0.00000	-0.00000	0.00000	0.00219
24	0.00208	-0.47282	-0.94433	-0.00000	-0.00000	0.00000	0.00218
24	0.00417	-0.47282	-0.93979	-0.00000	-0.00000	0.00000	0.00218
24	0.00625	-0.47282	-0.93525	-0.00000	-0.00000	0.00000	0.00218
24	0.00833	-0.47282	-0.93071	-0.00000	-0.00000	0.00000	0.00218
24	0.01042	-0.47282	-0.92618	-0.00000	-0.00000	0.00000	0.00217
24	0.01250	-0.47282	-0.92166	-0.00000	-0.00000	0.00000	0.00217

24	0.01458	-0.47282	-0.91714	-0.00000	-0.00000	0.00000	0.00217
24	0.01667	-0.47282	-0.91262	-0.00000	-0.00000	0.00000	0.00217
24	0.01875	-0.47282	-0.90811	-0.00000	-0.00000	0.00000	0.00216
24	0.02083	-0.47282	-0.90360	-0.00000	-0.00000	0.00000	0.00216
24	0.02292	-0.47282	-0.89910	-0.00000	-0.00000	0.00000	0.00216
24	0.02500	-0.47282	-0.89460	-0.00000	-0.00000	0.00000	0.00216
24	0.02708	-0.47282	-0.89010	-0.00000	-0.00000	0.00000	0.00216
24	0.02917	-0.47282	-0.88560	-0.00000	-0.00000	0.00000	0.00216
24	0.03125	-0.47282	-0.88111	-0.00000	-0.00000	0.00000	0.00216
24	0.03333	-0.47282	-0.87662	-0.00000	-0.00000	0.00000	0.00215
24	0.03542	-0.47282	-0.87213	-0.00000	-0.00000	0.00000	0.00215
24	0.03750	-0.47282	-0.86764	-0.00000	-0.00000	0.00000	0.00215
24	0.03958	-0.47282	-0.86316	-0.00000	-0.00000	0.00000	0.00215
24	0.04167	-0.47282	-0.85867	-0.00000	-0.00000	0.00000	0.00215
24	0.04375	-0.47282	-0.85419	-0.00000	-0.00000	0.00000	0.00215
24	0.04583	-0.47282	-0.84971	-0.00000	-0.00000	0.00000	0.00215
24	0.04792	-0.47282	-0.84523	-0.00000	-0.00000	0.00000	0.00215
24	0.05000	-0.47282	-0.84075	-0.00000	-0.00000	0.00000	0.00215
25	0.00000	-0.10151	-0.00843	0.02953	0.00002	0.00076	0.00017
25	0.00295	-0.10148	-0.00792	0.02734	0.00002	0.00073	0.00017
25	0.00589	-0.10146	-0.00740	0.02521	0.00002	0.00071	0.00017
25	0.00884	-0.10143	-0.00689	0.02314	0.00002	0.00069	0.00017
25	0.01179	-0.10140	-0.00638	0.02114	0.00002	0.00067	0.00017
25	0.01473	-0.10138	-0.00588	0.01919	0.00002	0.00065	0.00017
25	0.01768	-0.10135	-0.00537	0.01730	0.00002	0.00063	0.00017
25	0.02062	-0.10132	-0.00486	0.01547	0.00003	0.00061	0.00017
25	0.02357	-0.10129	-0.00436	0.01369	0.00003	0.00060	0.00017
25	0.02652	-0.10127	-0.00386	0.01195	0.00003	0.00058	0.00017
25	0.02946	-0.10124	-0.00335	0.01027	0.00003	0.00056	0.00017
25	0.03241	-0.10121	-0.00285	0.00863	0.00003	0.00055	0.00017
25	0.03536	-0.10119	-0.00235	0.00704	0.00003	0.00053	0.00017
25	0.03830	-0.10116	-0.00186	0.00549	0.00003	0.00052	0.00017
25	0.04125	-0.10113	-0.00136	0.00398	0.00003	0.00051	0.00017
25	0.04419	-0.10110	-0.00086	0.00250	0.00003	0.00049	0.00017
25	0.04714	-0.10108	-0.00037	0.00106	0.00003	0.00048	0.00017
25	0.05009	-0.10105	0.00013	-0.00034	0.00003	0.00047	0.00017
25	0.05303	-0.10102	0.00062	-0.00172	0.00003	0.00046	0.00017
25	0.05598	-0.10100	0.00111	-0.00306	0.00003	0.00045	0.00017
25	0.05893	-0.10097	0.00160	-0.00438	0.00003	0.00044	0.00017
25	0.06187	-0.10094	0.00209	-0.00567	0.00003	0.00043	0.00017
25	0.06482	-0.10091	0.00258	-0.00694	0.00003	0.00043	0.00017
25	0.06776	-0.10089	0.00307	-0.00819	0.00003	0.00042	0.00017
25	0.07071	-0.10086	0.00355	-0.00942	0.00003	0.00041	0.00016
26	0.00000	-0.04332	0.00355	0.09157	0.00017	0.00041	0.00002
26	0.03449	-0.04224	0.00430	0.07837	0.00016	0.00035	0.00002
26	0.06897	-0.04116	0.00490	0.06725	0.00015	0.00029	0.00002
26	0.10346	-0.04008	0.00538	0.05805	0.00015	0.00024	0.00001
26	0.13794	-0.03900	0.00573	0.05057	0.00014	0.00019	0.00001
26	0.17243	-0.03792	0.00597	0.04466	0.00013	0.00015	0.00001
26	0.20691	-0.03683	0.00611	0.04013	0.00013	0.00011	0.00000
26	0.24140	-0.03575	0.00615	0.03681	0.00012	0.00008	-0.00000
26	0.27588	-0.03467	0.00610	0.03454	0.00011	0.00005	-0.00000
26	0.31037	-0.03359	0.00597	0.03314	0.00011	0.00003	-0.00000
26	0.34485	-0.03251	0.00577	0.03246	0.00010	0.00001	-0.00001
26	0.37934	-0.03143	0.00551	0.03231	0.00009	-0.00000	-0.00001
26	0.41382	-0.03035	0.00520	0.03254	0.00009	-0.00001	-0.00001
26	0.44831	-0.02927	0.00485	0.03298	0.00008	-0.00001	-0.00001
26	0.48279	-0.02820	0.00446	0.03347	0.00007	-0.00001	-0.00001
26	0.51728	-0.02712	0.00405	0.03385	0.00007	-0.00001	-0.00001
26	0.55176	-0.02604	0.00361	0.03397	0.00006	0.00000	-0.00001
26	0.58625	-0.02496	0.00317	0.03366	0.00006	0.00002	-0.00001
26	0.62074	-0.02388	0.00273	0.03276	0.00005	0.00004	-0.00001
26	0.65522	-0.02280	0.00230	0.03113	0.00004	0.00006	-0.00001
26	0.68971	-0.02173	0.00189	0.02860	0.00004	0.00009	-0.00001
26	0.72419	-0.02065	0.00150	0.02503	0.00003	0.00012	-0.00001
26	0.75868	-0.01957	0.00115	0.02026	0.00002	0.00016	-0.00001
26	0.79316	-0.01849	0.00084	0.01415	0.00002	0.00020	-0.00001
26	0.82765	-0.01742	0.00058	0.00654	0.00001	0.00024	-0.00001

MEMBER STRESSES (m, MPa)

Member	Station Location	Axial Torsion	Shear Y Shear Z	Top Mom Z Btm Mom Z	Top Mom Y Btm Mom Y	Ax + Top Mom Z Ax + Btm Mom Z	Ax + Top Mom Y Ax + Btm Mom Y
1	0.00000	0.00000	0.00000	-0.00000	0.11206	-0.00000	0.11206
		0.00000	-0.05992	0.00000	-0.11206	0.00000	-0.11206
1	0.04167	0.00000	0.00000	-0.00000	0.06070	-0.00000	0.06070
		0.00000	-0.04993	0.00000	-0.06070	0.00000	-0.06070
1	0.08333	0.00000	0.00000	-0.00000	0.01868	-0.00000	0.01868
		0.00000	-0.03995	0.00000	-0.01868	0.00000	-0.01868

1	0.12500	0.00000	0.00000	0.00000	-0.01401	0.00000	-0.01401
		0.00000	-0.02996	-0.00000	0.01401	-0.00000	0.01401
1	0.16667	0.00000	0.00000	0.00000	-0.03735	0.00000	-0.03735
		0.00000	-0.01997	-0.00000	0.03735	-0.00000	0.03735
1	0.20833	0.00000	0.00000	0.00000	-0.05136	0.00000	-0.05136
		0.00000	-0.00999	-0.00000	0.05136	-0.00000	0.05136
1	0.25000	0.00000	-0.00000	0.00000	-0.05603	0.00000	-0.05603
		0.00000	-0.00000	-0.00000	0.05603	-0.00000	0.05603
1	0.29167	0.00000	-0.00000	0.00000	-0.05136	0.00000	-0.05136
		0.00000	0.00999	-0.00000	0.05136	-0.00000	0.05136
1	0.33333	0.00000	-0.00000	0.00000	-0.03735	0.00000	-0.03735
		0.00000	0.01997	-0.00000	0.03735	-0.00000	0.03735
1	0.37500	0.00000	-0.00000	0.00000	-0.01401	0.00000	-0.01401
		0.00000	0.02996	-0.00000	0.01401	-0.00000	0.01401
1	0.41667	0.00000	-0.00000	-0.00000	0.01868	-0.00000	0.01868
		0.00000	0.03995	0.00000	-0.01868	0.00000	-0.01868
1	0.45833	0.00000	-0.00000	-0.00000	0.06070	-0.00000	0.06070
		0.00000	0.04993	0.00000	-0.06070	0.00000	-0.06070
1	0.50000	0.00000	0.00000	-0.00000	0.00700	-0.00000	0.00700
		0.00000	-0.01498	0.00000	-0.00700	0.00000	-0.00700
1	0.51042	0.00000	0.00000	-0.00000	0.00379	-0.00000	0.00379
		0.00000	-0.01248	0.00000	-0.00379	0.00000	-0.00379
1	0.52083	0.00000	0.00000	-0.00000	0.00117	-0.00000	0.00117
		0.00000	-0.00999	0.00000	-0.00117	0.00000	-0.00117
1	0.53125	0.00000	0.00000	0.00000	-0.00088	0.00000	-0.00088
		0.00000	-0.00749	-0.00000	0.00088	-0.00000	0.00088
1	0.54167	0.00000	0.00000	0.00000	-0.00233	0.00000	-0.00233
		0.00000	-0.00499	-0.00000	0.00233	-0.00000	0.00233
1	0.55208	0.00000	0.00000	0.00000	-0.00321	0.00000	-0.00321
		0.00000	-0.00250	-0.00000	0.00321	-0.00000	0.00321
1	0.56250	0.00000	-0.00000	0.00000	-0.00350	0.00000	-0.00350
		0.00000	-0.00000	-0.00000	0.00350	-0.00000	0.00350
1	0.57292	0.00000	-0.00000	0.00000	-0.00321	0.00000	-0.00321
		0.00000	0.00250	-0.00000	0.00321	-0.00000	0.00321
1	0.58333	0.00000	-0.00000	0.00000	-0.00233	0.00000	-0.00233
		0.00000	0.00499	-0.00000	0.00233	-0.00000	0.00233
1	0.59375	0.00000	-0.00000	0.00000	-0.00088	0.00000	-0.00088
		0.00000	0.00749	-0.00000	0.00088	-0.00000	0.00088
1	0.60417	0.00000	-0.00000	-0.00000	0.00117	-0.00000	0.00117
		0.00000	0.00999	0.00000	-0.00117	0.00000	-0.00117
1	0.61458	0.00000	-0.00000	-0.00000	0.00379	-0.00000	0.00379
		0.00000	0.01248	0.00000	-0.00379	0.00000	-0.00379
1	0.62500	0.00000	-0.00000	-0.00000	0.00700	-0.00000	0.00700
		0.00000	0.01498	0.00000	-0.00700	0.00000	-0.00700
2	0.00000	1.71862	0.19461	-2.38247	43.79508	-0.66385	45.51370
		-1.77004	5.35096	2.38247	-43.79508	4.10109	-42.07646
2	0.00295	1.71878	0.19461	-2.36378	44.14890	-0.64500	45.86768
		-1.77004	5.35146	2.36378	-44.14890	4.08256	-42.43012
2	0.00589	1.71894	0.19461	-2.34509	44.50276	-0.62615	46.22170
		-1.77004	5.35196	2.34509	-44.50276	4.06403	-42.78381
2	0.00884	1.71910	0.19461	-2.32640	44.85664	-0.60730	46.57574
		-1.77004	5.35246	2.32640	-44.85664	4.04550	-43.13754
2	0.01179	1.71926	0.19461	-2.30771	45.21056	-0.58845	46.92982
		-1.77004	5.35296	2.30771	-45.21056	4.02697	-43.49130
2	0.01473	1.71942	0.19461	-2.28902	45.56452	-0.56960	47.28394
		-1.77004	5.35346	2.28902	-45.56452	4.00844	-43.84509
2	0.01768	1.71958	0.19461	-2.27033	45.91850	-0.55075	47.63808
		-1.77004	5.35396	2.27033	-45.91850	3.98991	-44.19892
2	0.02062	1.71974	0.19461	-2.25164	46.27252	-0.53190	47.99226
		-1.77004	5.35446	2.25164	-46.27252	3.97139	-44.55278
2	0.02357	1.71990	0.19461	-2.23295	46.62657	-0.51305	48.34648
		-1.77004	5.35496	2.23295	-46.62657	3.95286	-44.90667
2	0.02652	1.72006	0.19461	-2.21426	46.98066	-0.49420	48.70072
		-1.77004	5.35546	2.21426	-46.98066	3.93433	-45.26059
2	0.02946	1.72022	0.19461	-2.19557	47.33478	-0.47535	49.05500
		-1.77004	5.35595	2.19557	-47.33478	3.91580	-45.61455
2	0.03241	1.72038	0.19461	-2.17688	47.68893	-0.45650	49.40931
		-1.77004	5.35645	2.17688	-47.68893	3.89727	-45.96854
2	0.03536	1.72054	0.19461	-2.15820	48.04311	-0.43765	49.76366
		-1.77004	5.35695	2.15820	-48.04311	3.87874	-46.32257
2	0.03830	1.72071	0.19461	-2.13951	48.39733	-0.41880	50.11803
		-1.77004	5.35745	2.13951	-48.39733	3.86021	-46.67662
2	0.04125	1.72087	0.19461	-2.12082	48.75158	-0.39995	50.47244
		-1.77004	5.35795	2.12082	-48.75158	3.84168	-47.03071
2	0.04419	1.72103	0.19461	-2.10213	49.10586	-0.38110	50.82689
		-1.77004	5.35845	2.10213	-49.10586	3.82315	-47.38484
2	0.04714	1.72119	0.19461	-2.08344	49.46018	-0.36225	51.18136
		-1.77004	5.35895	2.08344	-49.46018	3.80462	-47.73899
2	0.05009	1.72135	0.19461	-2.06475	49.81453	-0.34340	51.53587
		-1.77004	5.35945	2.06475	-49.81453	3.78610	-48.09318

2	0.05303	1.72151	0.19461	-2.04606	50.16891	-0.32455	51.89042
		-1.77004	5.35995	2.04606	-50.16891	3.76757	-48.44740
2	0.05598	1.72167	0.19461	-2.02737	50.52332	-0.30570	52.24499
		-1.77004	5.36045	2.02737	-50.52332	3.74904	-48.80166
2	0.05893	1.72183	0.19461	-2.00868	50.87777	-0.28685	52.59960
		-1.77004	5.36095	2.00868	-50.87777	3.73051	-49.15594
2	0.06187	1.72199	0.19461	-1.98999	51.23225	-0.26800	52.95424
		-1.77004	5.36145	1.98999	-51.23225	3.71198	-49.51027
2	0.06482	1.72215	0.19461	-1.97130	51.58677	-0.24915	53.30892
		-1.77004	5.36195	1.97130	-51.58677	3.69345	-49.86462
2	0.06776	1.72231	0.19461	-1.95261	51.94132	-0.23030	53.66362
		-1.77004	5.36245	1.95261	-51.94132	3.67492	-50.21901
2	0.07071	1.72247	0.19461	-1.93392	52.29590	-0.21145	54.01837
		-1.77004	5.36295	1.93392	-52.29590	3.65639	-50.57343
3	0.00000	1.07540	0.19461	-3.66026	-6.88213	-2.58486	-5.80673
		-2.25881	6.69658	3.66026	6.88213	4.73566	7.95753
3	0.00466	1.07556	0.19461	-3.63071	-6.18199	-2.55515	-5.10642
		-2.25881	6.69758	3.63071	6.18199	4.70627	7.25755
3	0.00932	1.07572	0.19461	-3.60116	-5.48174	-2.52543	-4.40601
		-2.25881	6.69858	3.60116	5.48174	4.67688	6.55746
3	0.01398	1.07588	0.19461	-3.57161	-4.78138	-2.49572	-3.70550
		-2.25881	6.69958	3.57161	4.78138	4.64749	5.85727
3	0.01863	1.07605	0.19461	-3.54206	-4.08093	-2.46601	-3.00488
		-2.25881	6.70058	3.54206	4.08093	4.61810	5.15697
3	0.02329	1.07621	0.19461	-3.51251	-3.38037	-2.43630	-2.30416
		-2.25881	6.70158	3.51251	3.38037	4.58871	4.45657
3	0.02795	1.07637	0.19461	-3.48296	-2.67970	-2.40659	-1.60333
		-2.25881	6.70258	3.48296	2.67970	4.55932	3.75607
3	0.03261	1.07653	0.19461	-3.45341	-1.97893	-2.37688	-0.90240
		-2.25881	6.70358	3.45341	1.97893	4.52993	3.05546
3	0.03727	1.07669	0.19461	-3.42386	-1.27806	-2.34717	-0.20137
		-2.25881	6.70457	3.42386	1.27806	4.50054	2.35474
3	0.04193	1.07685	0.19461	-3.39431	-0.57708	-2.31746	0.49977
		-2.25881	6.70557	3.39431	0.57708	4.47115	1.65392
3	0.04658	1.07701	0.19461	-3.36476	0.12401	-2.28775	1.20101
		-2.25881	6.70657	3.36476	-0.12401	4.44176	0.95300
3	0.05124	1.07717	0.19461	-3.33520	0.82519	-2.25804	1.90236
		-2.25881	6.70757	3.33520	-0.82519	4.41237	0.25197
3	0.05590	1.07733	0.19461	-3.30565	1.52649	-2.22833	2.60381
		-2.25881	6.70857	3.30565	-1.52649	4.38298	-0.44916
3	0.06056	1.07749	0.19461	-3.27610	2.22788	-2.19862	3.30537
		-2.25881	6.70957	3.27610	-2.22788	4.35359	-1.15039
3	0.06522	1.07765	0.19461	-3.24655	2.92938	-2.16890	4.00703
		-2.25881	6.71057	3.24655	-2.92938	4.32420	-1.85173
3	0.06988	1.07781	0.19461	-3.21700	3.63099	-2.13919	4.70880
		-2.25881	6.71156	3.21700	-3.63099	4.29481	-2.55318
3	0.07454	1.07797	0.19461	-3.18745	4.33270	-2.10948	5.41067
		-2.25881	6.71256	3.18745	-4.33270	4.26542	-3.25473
3	0.07919	1.07813	0.19461	-3.15790	5.03451	-2.07977	6.11264
		-2.25881	6.71356	3.15790	-5.03451	4.23603	-3.95638
3	0.08385	1.07829	0.19461	-3.12835	5.73643	-2.05006	6.81472
		-2.25881	6.71456	3.12835	-5.73643	4.20664	-4.65814
3	0.08851	1.07845	0.19461	-3.09880	6.43845	-2.02035	7.51691
		-2.25881	6.71556	3.09880	-6.43845	4.17725	-5.36000
3	0.09317	1.07861	0.19461	-3.06925	7.14058	-1.99064	8.21919
		-2.25881	6.71656	3.06925	-7.14058	4.14786	-6.06197
3	0.09783	1.07877	0.19461	-3.03970	7.84281	-1.96093	8.92159
		-2.25881	6.71756	3.03970	-7.84281	4.11847	-6.76404
3	0.10249	1.07893	0.19461	-3.01015	8.54515	-1.93122	9.62408
		-2.25881	6.71856	3.01015	-8.54515	4.08908	-7.46622
3	0.10714	1.07909	0.19461	-2.98060	9.24759	-1.90151	10.32668
		-2.25881	6.71955	2.98060	-9.24759	4.05969	-8.16850
3	0.11180	1.07925	0.19461	-2.95105	9.95014	-1.87180	11.02939
		-2.25881	6.72055	2.95105	-9.95014	4.03030	-8.87088
4	0.00000	5.41388	0.24446	-0.31387	9.77755	5.10000	15.19143
		-1.09329	-17.27834	0.31387	-9.77755	5.72775	-4.36368
4	0.00417	5.41420	0.24446	-0.28067	8.16190	5.13352	13.57609
		-1.09329	-17.27834	0.28067	-8.16190	5.69487	-2.74770
4	0.00833	5.41452	0.24446	-0.24747	6.54624	5.16704	11.96076
		-1.09329	-17.27834	0.24747	-6.54624	5.66199	-1.13173
4	0.01250	5.41484	0.24446	-0.21427	4.93059	5.20056	10.34543
		-1.09329	-17.27834	0.21427	-4.93059	5.62911	0.48425
4	0.01667	5.41516	0.24446	-0.18107	3.31494	5.23409	8.73009
		-1.09329	-17.27834	0.18107	-3.31494	5.59623	2.10022
4	0.02083	5.41548	0.24446	-0.14787	1.69928	5.26761	7.11476
		-1.09329	-17.27834	0.14787	-1.69928	5.56335	3.71620
4	0.02500	5.41580	0.24446	-0.11467	0.08363	5.30113	5.49943
		-1.09329	-17.27834	0.11467	-0.08363	5.53047	5.33217
4	0.02917	5.41612	0.24446	-0.08147	-1.53203	5.33465	3.88409

		-1.09329	-17.27834	0.08147	1.53203	5.49759	6.94815
4	0.03333	5.41644	0.24446	-0.04827	-3.14768	5.36817	2.26876
		-1.09329	-17.27834	0.04827	3.14768	5.46471	8.56412
4	0.03750	5.41676	0.24446	-0.01507	-4.76333	5.40169	0.65343
		-1.09329	-17.27834	0.01507	4.76333	5.43184	10.18010
4	0.04167	5.41708	0.24446	0.01813	-6.37899	5.43521	-0.96190
		-1.09329	-17.27834	-0.01813	6.37899	5.39896	11.79607
4	0.04583	5.41740	0.24446	0.05133	-7.99464	5.46873	-2.57724
		-1.09329	-17.27834	-0.05133	7.99464	5.36608	13.41205
4	0.05000	5.41772	0.24446	0.08453	-9.61030	5.50225	-4.19257
		-1.09329	-17.27834	-0.08453	9.61030	5.33320	15.02802
4	0.05417	5.41805	0.24446	0.11773	-11.22595	5.53577	-5.80790
		-1.09329	-17.27834	-0.11773	11.22595	5.30032	16.64399
4	0.05833	5.41837	0.24446	0.15093	-12.84160	5.56929	-7.42324
		-1.09329	-17.27834	-0.15093	12.84160	5.26744	18.25997
4	0.06250	5.41869	0.24446	0.18413	-14.45726	5.60281	-9.03857
		-1.09329	-17.27834	-0.18413	14.45726	5.23456	19.87594
4	0.06667	5.41901	0.24446	0.21733	-16.07291	5.63633	-10.65390
		-1.09329	-17.27834	-0.21733	16.07291	5.20168	21.49192
4	0.07083	5.41933	0.24446	0.25053	-17.68856	5.66986	-12.26924
		-1.09329	-17.27834	-0.25053	17.68856	5.16880	23.10789
4	0.07500	5.41965	0.24446	0.28373	-19.30422	5.70338	-13.88457
		-1.09329	-17.27834	-0.28373	19.30422	5.13592	24.72387
4	0.07917	5.41997	0.24446	0.31693	-20.91987	5.73690	-15.49990
		-1.09329	-17.27834	-0.31693	20.91987	5.10304	26.33984
4	0.08333	5.42029	0.24446	0.35013	-22.53553	5.77042	-17.11524
		-1.09329	-17.27834	-0.35013	22.53553	5.07016	27.95582
4	0.08750	5.42061	0.24446	0.38333	-24.15118	5.80394	-18.73057
		-1.09329	-17.27834	-0.38333	24.15118	5.03728	29.57179
4	0.09167	5.42093	0.24446	0.41653	-25.76683	5.83746	-20.34590
		-1.09329	-17.27834	-0.41653	25.76683	5.00441	31.18777
4	0.09583	5.42125	0.24446	0.44973	-27.38249	5.87098	-21.96123
		-1.09329	-17.27834	-0.44973	27.38249	4.97153	32.80374
4	0.10000	5.42157	0.24446	0.48293	-28.99814	5.90450	-23.57657
		-1.09329	-17.27834	-0.48293	28.99814	4.93865	34.41971
5	0.00000	-2.87612	-0.04984	-0.77752	-7.01080	-3.65364	-9.88691
		0.05462	17.27834	0.77752	7.01080	-2.09859	4.13468
5	0.00417	-2.87580	-0.04984	-0.78429	-5.39514	-3.66009	-8.27094
		0.05462	17.27834	0.78429	5.39514	-2.09150	2.51935
5	0.00833	-2.87548	-0.04984	-0.79106	-3.77949	-3.66654	-6.65497
		0.05462	17.27834	0.79106	3.77949	-2.08441	0.90401
5	0.01250	-2.87516	-0.04984	-0.79783	-2.16384	-3.67299	-5.03899
		0.05462	17.27834	0.79783	2.16384	-2.07732	-0.71132
5	0.01667	-2.87483	-0.04984	-0.80460	-0.54818	-3.67944	-3.42302
		0.05462	17.27834	0.80460	0.54818	-2.07023	-2.32665
5	0.02083	-2.87451	-0.04984	-0.81137	1.06747	-3.68588	-1.80704
		0.05462	17.27834	0.81137	-1.06747	-2.06314	-3.94199
5	0.02500	-2.87419	-0.04984	-0.81814	2.68313	-3.69233	-0.19107
		0.05462	17.27834	0.81814	-2.68313	-2.05605	-5.55732
5	0.02917	-2.87387	-0.04984	-0.82491	4.29878	-3.69878	1.42491
		0.05462	17.27834	0.82491	-4.29878	-2.04896	-7.17265
5	0.03333	-2.87355	-0.04984	-0.83168	5.91443	-3.70523	3.04088
		0.05462	17.27834	0.83168	-5.91443	-2.04187	-8.78798
5	0.03750	-2.87323	-0.04984	-0.83845	7.53009	-3.71168	4.65686
		0.05462	17.27834	0.83845	-7.53009	-2.03478	-10.40332
5	0.04167	-2.87291	-0.04984	-0.84522	9.14574	-3.71813	6.27283
		0.05462	17.27834	0.84522	-9.14574	-2.02769	-12.01865
5	0.04583	-2.87259	-0.04984	-0.85199	10.76139	-3.72458	7.88881
		0.05462	17.27834	0.85199	-10.76139	-2.02060	-13.63398
5	0.05000	-2.87227	-0.04984	-0.85876	12.37705	-3.73102	9.50478
		0.05462	17.27834	0.85876	-12.37705	-2.01351	-15.24932
5	0.05417	-2.87195	-0.04984	-0.86553	13.99270	-3.73747	11.12076
		0.05462	17.27834	0.86553	-13.99270	-2.00642	-16.86465
5	0.05833	-2.87163	-0.04984	-0.87229	15.60836	-3.74392	12.73673
		0.05462	17.27834	0.87229	-15.60836	-1.99933	-18.47998
5	0.06250	-2.87131	-0.04984	-0.87906	17.22401	-3.75037	14.35270
		0.05462	17.27834	0.87906	-17.22401	-1.99224	-20.09532
5	0.06667	-2.87099	-0.04984	-0.88583	18.83966	-3.75682	15.96868
		0.05462	17.27834	0.88583	-18.83966	-1.98515	-21.71065
5	0.07083	-2.87066	-0.04984	-0.89260	20.45532	-3.76327	17.58465
		0.05462	17.27834	0.89260	-20.45532	-1.97806	-23.32598
5	0.07500	-2.87034	-0.04984	-0.89937	22.07097	-3.76972	19.20063
		0.05462	17.27834	0.89937	-22.07097	-1.97097	-24.94132
5	0.07917	-2.87002	-0.04984	-0.90614	23.68663	-3.77616	20.81660
		0.05462	17.27834	0.90614	-23.68663	-1.96388	-26.55665
5	0.08333	-2.86970	-0.04984	-0.91291	25.30228	-3.78261	22.43258
		0.05462	17.27834	0.91291	-25.30228	-1.95679	-28.17198
5	0.08750	-2.86938	-0.04984	-0.91968	26.91793	-3.78906	24.04855
		0.05462	17.27834	0.91968	-26.91793	-1.94970	-29.78731
5	0.09167	-2.86906	-0.04984	-0.92645	28.53359	-3.79551	25.66453

		0.05462	17.27834	0.92645	-28.53359	-1.94261	-31.40265
5	0.09583	-2.86874	-0.04984	-0.93322	30.14924	-3.80196	27.28050
		0.05462	17.27834	0.93322	-30.14924	-1.93552	-33.01798
5	0.10000	-2.86842	-0.04984	-0.93999	31.76489	-3.80841	28.89648
		0.05462	17.27834	0.93999	-31.76489	-1.92843	-34.63331
6	0.00000	0.00000	0.00000	0.00000	0.00000	0.00000	0.00000
		0.00000	0.00000	0.00000	0.00000	0.00000	0.00000
6	0.00417	0.00032	0.00000	0.00000	0.00000	0.00032	0.00032
		0.00000	0.00000	0.00000	0.00000	0.00032	0.00032
6	0.00833	0.00064	0.00000	0.00000	0.00000	0.00064	0.00064
		0.00000	0.00000	0.00000	0.00000	0.00064	0.00064
6	0.01250	0.00096	0.00000	0.00000	0.00000	0.00096	0.00096
		0.00000	0.00000	0.00000	0.00000	0.00096	0.00096
6	0.01667	0.00128	0.00000	0.00000	0.00000	0.00128	0.00128
		0.00000	0.00000	0.00000	0.00000	0.00128	0.00128
6	0.02083	0.00160	0.00000	0.00000	0.00000	0.00160	0.00160
		0.00000	0.00000	0.00000	0.00000	0.00160	0.00160
6	0.02500	0.00192	0.00000	0.00000	0.00000	0.00192	0.00192
		0.00000	0.00000	0.00000	0.00000	0.00192	0.00192
6	0.02917	0.00225	0.00000	0.00000	0.00000	0.00225	0.00225
		0.00000	0.00000	0.00000	0.00000	0.00225	0.00225
6	0.03333	0.00257	0.00000	0.00000	0.00000	0.00257	0.00257
		0.00000	0.00000	0.00000	0.00000	0.00257	0.00257
6	0.03750	0.00289	0.00000	0.00000	0.00000	0.00289	0.00289
		0.00000	0.00000	0.00000	0.00000	0.00289	0.00289
6	0.04167	0.00321	0.00000	0.00000	0.00000	0.00321	0.00321
		0.00000	0.00000	0.00000	0.00000	0.00321	0.00321
6	0.04583	0.00353	0.00000	0.00000	0.00000	0.00353	0.00353
		0.00000	0.00000	0.00000	0.00000	0.00353	0.00353
6	0.05000	0.00385	0.00000	0.00000	0.00000	0.00385	0.00385
		0.00000	0.00000	0.00000	0.00000	0.00385	0.00385
6	0.05417	0.00417	0.00000	0.00000	0.00000	0.00417	0.00417
		0.00000	0.00000	0.00000	0.00000	0.00417	0.00417
6	0.05833	0.00449	0.00000	0.00000	0.00000	0.00449	0.00449
		0.00000	0.00000	0.00000	0.00000	0.00449	0.00449
6	0.06250	0.00481	0.00000	0.00000	0.00000	0.00481	0.00481
		0.00000	0.00000	0.00000	0.00000	0.00481	0.00481
6	0.06667	0.00513	0.00000	0.00000	0.00000	0.00513	0.00513
		0.00000	0.00000	0.00000	0.00000	0.00513	0.00513
6	0.07083	0.00545	0.00000	0.00000	0.00000	0.00545	0.00545
		0.00000	0.00000	0.00000	0.00000	0.00545	0.00545
6	0.07500	0.00577	0.00000	0.00000	0.00000	0.00577	0.00577
		0.00000	0.00000	0.00000	0.00000	0.00577	0.00577
6	0.07917	0.00609	0.00000	0.00000	0.00000	0.00609	0.00609
		0.00000	0.00000	0.00000	0.00000	0.00609	0.00609
6	0.08333	0.00642	0.00000	0.00000	0.00000	0.00642	0.00642
		0.00000	0.00000	0.00000	0.00000	0.00642	0.00642
6	0.08750	0.00674	0.00000	0.00000	0.00000	0.00674	0.00674
		0.00000	0.00000	0.00000	0.00000	0.00674	0.00674
6	0.09167	0.00706	0.00000	0.00000	0.00000	0.00706	0.00706
		0.00000	0.00000	0.00000	0.00000	0.00706	0.00706
6	0.09583	0.00738	0.00000	0.00000	0.00000	0.00738	0.00738
		0.00000	0.00000	0.00000	0.00000	0.00738	0.00738
6	0.10000	0.00770	0.00000	0.00000	0.00000	0.00770	0.00770
		0.00000	0.00000	0.00000	0.00000	0.00770	0.00770
7	0.00000	0.00000	-0.00645	-0.00000	0.00000	-0.00000	0.00000
		0.00404	0.00000	0.00000	-0.00000	0.00000	-0.00000
7	0.03333	0.00000	-0.05470	-0.03322	0.00000	-0.03322	0.00000
		0.00404	0.00000	0.03322	-0.00000	0.03322	-0.00000
7	0.06667	0.00000	-0.10295	-0.11886	0.00000	-0.11886	0.00000
		0.00404	0.00000	0.11886	-0.00000	0.11886	-0.00000
7	0.10000	0.00000	-0.15119	-0.25692	0.00000	-0.25692	0.00000
		0.00404	0.00000	0.25692	-0.00000	0.25692	-0.00000
7	0.13333	0.00000	-0.19944	-0.44740	0.00000	-0.44740	0.00000
		0.00404	0.00000	0.44740	-0.00000	0.44740	-0.00000
7	0.16667	0.00000	-0.24769	-0.69031	0.00000	-0.69031	0.00000
		0.00404	0.00000	0.69031	-0.00000	0.69031	-0.00000
7	0.20000	0.11614	3.73358	-5.24872	2.50835	-5.13258	2.62449
		-4.13461	0.00000	5.24872	-2.50835	5.36486	-2.39221
7	0.25000	0.11614	3.66121	0.77706	2.50835	0.89320	2.62449
		-4.13461	0.00000	-0.77706	-2.50835	-0.66092	-2.39221
7	0.30000	0.11614	3.58884	6.68489	2.50835	6.80103	2.62449
		-4.13461	0.00000	-6.68489	-2.50835	-6.56875	-2.39221
7	0.35000	0.11614	3.51647	12.47477	2.50835	12.59091	2.62449
		-4.13461	0.00000	-12.47477	-2.50835	-12.35863	-2.39221
7	0.40000	0.11614	3.44409	18.14671	2.50835	18.26285	2.62449
		-4.13461	0.00000	-18.14671	-2.50835	-18.03057	-2.39221
7	0.45000	0.11614	3.37172	23.70069	2.50835	23.81683	2.62449
		-4.13461	0.00000	-23.70069	-2.50835	-23.58455	-2.39221
7	0.50000	0.11614	-3.29935	29.13673	2.50835	29.25287	2.62449

		4.13461	0.00000	-29.13673	-2.50835	-29.02059	-2.39221
7	0.55000	0.11614	-3.37172	23.70069	2.50835	23.81683	2.62449
		4.13461	0.00000	-23.70069	-2.50835	-23.58455	-2.39221
7	0.60000	0.11614	-3.44409	18.14671	2.50835	18.26285	2.62449
		4.13461	0.00000	-18.14671	-2.50835	-18.03057	-2.39221
7	0.65000	0.11614	-3.51647	12.47477	2.50835	12.59091	2.62449
		4.13461	0.00000	-12.47477	-2.50835	-12.35863	-2.39221
7	0.70000	0.11614	-3.58884	6.68489	2.50835	6.80103	2.62449
		4.13461	0.00000	-6.68489	-2.50835	-6.56875	-2.39221
7	0.75000	0.11614	-3.66121	0.77706	2.50835	0.89320	2.62449
		4.13461	0.00000	-0.77706	-2.50835	-0.66092	-2.39221
7	0.80000	-0.00000	0.29594	-0.98563	0.00000	-0.98563	-0.00000
		-0.00404	-0.00000	0.98563	-0.00000	0.98563	-0.00000
7	0.83333	-0.00000	0.24769	-0.69031	0.00000	-0.69031	0.00000
		-0.00404	0.00000	0.69031	-0.00000	0.69031	-0.00000
7	0.86667	-0.00000	0.19944	-0.44740	0.00000	-0.44740	0.00000
		-0.00404	0.00000	0.44740	-0.00000	0.44740	-0.00000
7	0.90000	-0.00000	0.15119	-0.25692	0.00000	-0.25692	0.00000
		-0.00404	0.00000	0.25692	-0.00000	0.25692	-0.00000
7	0.93333	-0.00000	0.10295	-0.11886	0.00000	-0.11886	0.00000
		-0.00404	0.00000	0.11886	-0.00000	0.11886	-0.00000
7	0.96667	-0.00000	0.05470	-0.03322	0.00000	-0.03322	0.00000
		-0.00404	0.00000	0.03322	-0.00000	0.03322	-0.00000
7	1.00000	-0.00000	0.00645	-0.00000	-0.00000	-0.00000	-0.00000
		-0.00404	-0.00000	0.00000	0.00000	0.00000	0.00000
8	0.00000	1.07925	0.19461	-2.95105	9.95014	-1.87180	11.02939
		-2.25881	6.72055	2.95105	-9.95014	4.03030	-8.87088
8	0.00932	1.07957	0.19461	-2.89195	11.35554	-1.81237	12.43511
		-2.25881	6.72255	2.89195	-11.35554	3.97152	-10.27597
8	0.01863	1.07989	0.19461	-2.83285	12.76136	-1.75295	13.84125
		-2.25881	6.72455	2.83285	-12.76136	3.91274	-11.68147
8	0.02795	1.08021	0.19461	-2.77375	14.16760	-1.69353	15.24781
		-2.25881	6.72655	2.77375	-14.16760	3.85396	-13.08738
8	0.03727	1.08054	0.19461	-2.71464	15.57425	-1.63411	16.65479
		-2.25881	6.72854	2.71464	-15.57425	3.79518	-14.49372
8	0.04658	1.08086	0.19461	-2.65554	16.98133	-1.57469	18.06219
		-2.25881	6.73054	2.65554	-16.98133	3.73640	-15.90047
8	0.05590	1.08118	0.19461	-2.59644	18.38882	-1.51527	19.47000
		-2.25881	6.73254	2.59644	-18.38882	3.67762	-17.30764
8	0.06522	1.08150	0.19461	-2.53734	19.79673	-1.45584	20.87823
		-2.25881	6.73453	2.53734	-19.79673	3.61884	-18.71523
8	0.07454	1.08182	0.19461	-2.47824	21.20506	-1.39642	22.28687
		-2.25881	6.73653	2.47824	-21.20506	3.56006	-20.12324
8	0.08385	1.08214	0.19461	-2.41914	22.61380	-1.33700	23.69594
		-2.25881	6.73853	2.41914	-22.61380	3.50128	-21.53166
8	0.09317	1.08246	0.19461	-2.36004	24.02296	-1.27758	25.10542
		-2.25881	6.74053	2.36004	-24.02296	3.44250	-22.94050
8	0.10249	1.08278	0.19461	-2.30094	25.43254	-1.21816	26.51532
		-2.25881	6.74252	2.30094	-25.43254	3.38372	-24.34976
8	0.11180	1.08310	0.19461	-2.24184	26.84254	-1.15874	27.92564
		-2.25881	6.74452	2.24184	-26.84254	3.32494	-25.75944
8	0.12112	1.08342	0.19461	-2.18274	28.25295	-1.09931	29.33638
		-2.25881	6.74652	2.18274	-28.25295	3.26616	-27.16953
8	0.13044	1.08374	0.19461	-2.12364	29.66379	-1.03989	30.74753
		-2.25881	6.74852	2.12364	-29.66379	3.20738	-28.58004
8	0.13975	1.08406	0.19461	-2.06453	31.07504	-0.98047	32.15910
		-2.25881	6.75051	2.06453	-31.07504	3.14860	-29.99097
8	0.14907	1.08438	0.19461	-2.00543	32.48670	-0.92105	33.57109
		-2.25881	6.75251	2.00543	-32.48670	3.08982	-31.40232
8	0.15839	1.08471	0.19461	-1.94633	33.89879	-0.86163	34.98350
		-2.25881	6.75451	1.94633	-33.89879	3.03104	-32.81408
8	0.16771	1.08503	0.19461	-1.88723	35.31129	-0.80221	36.39632
		-2.25881	6.75651	1.88723	-35.31129	2.97226	-34.22627
8	0.17702	1.08535	0.19461	-1.82813	36.72421	-0.74278	37.80956
		-2.25881	6.75850	1.82813	-36.72421	2.91348	-35.63887
8	0.18634	1.08567	0.19461	-1.76903	38.13755	-0.68336	39.22322
		-2.25881	6.76050	1.76903	-38.13755	2.85470	-37.05188
8	0.19566	1.08599	0.19461	-1.70993	39.55131	-0.62394	40.63730
		-2.25881	6.76250	1.70993	-39.55131	2.79592	-38.46532
8	0.20497	1.08631	0.19461	-1.65083	40.96548	-0.56452	42.05179
		-2.25881	6.76450	1.65083	-40.96548	2.73714	-39.87917
8	0.21429	1.08663	0.19461	-1.59173	42.38007	-0.50510	43.46670
		-2.25881	6.76649	1.59173	-42.38007	2.67836	-41.29344
8	0.22361	1.08695	0.19461	-1.53263	43.79508	-0.44568	44.88203
		-2.25881	6.76849	1.53263	-43.79508	2.61958	-42.70813
9	0.00000	7.72915	0.24446	-2.59759	12.96179	5.13156	20.69094
		-0.94382	-0.37039	2.59759	-12.96179	10.32673	-5.23264
9	0.01768	7.73011	0.24446	-2.45673	12.81545	5.27338	20.54556
		-0.94382	-0.36739	2.45673	-12.81545	10.18684	-5.08534
9	0.03536	7.73107	0.24446	-2.31587	12.67029	5.41520	20.40136

		-0.94382	-0.36440	2.31587	-12.67029	10.04695	-4.93922
9	0.05303	7.73203	0.24446	-2.17502	12.52632	5.55702	20.25836
		-0.94382	-0.36140	2.17502	-12.52632	9.90705	-4.79429
9	0.07071	7.73300	0.24446	-2.03416	12.38354	5.69883	20.11654
		-0.94382	-0.35840	2.03416	-12.38354	9.76716	-4.65054
9	0.08839	7.73396	0.24446	-1.89331	12.24195	5.84065	19.97591
		-0.94382	-0.35541	1.89331	-12.24195	9.62727	-4.50799
9	0.10607	7.73492	0.24446	-1.75245	12.10155	5.98247	19.83647
		-0.94382	-0.35241	1.75245	-12.10155	9.48737	-4.36663
9	0.12374	7.73588	0.24446	-1.61160	11.96233	6.12429	19.69822
		-0.94382	-0.34942	1.61160	-11.96233	9.34748	-4.22645
9	0.14142	7.73685	0.24446	-1.47074	11.82431	6.26610	19.56115
		-0.94382	-0.34642	1.47074	-11.82431	9.20759	-4.08746
9	0.15910	7.73781	0.24446	-1.32989	11.68747	6.40792	19.42528
		-0.94382	-0.34342	1.32989	-11.68747	9.06769	-3.94966
9	0.17678	7.73877	0.24446	-1.18903	11.55182	6.54974	19.29059
		-0.94382	-0.34043	1.18903	-11.55182	8.92780	-3.81305
9	0.19445	7.73973	0.24446	-1.04817	11.41736	6.69156	19.15710
		-0.94382	-0.33743	1.04817	-11.41736	8.78791	-3.67763
9	0.21213	7.74070	0.24446	-0.90732	11.28409	6.83338	19.02479
		-0.94382	-0.33444	0.90732	-11.28409	8.64801	-3.54340
9	0.22981	7.74166	0.24446	-0.76646	11.15201	6.97519	18.89367
		-0.94382	-0.33144	0.76646	-11.15201	8.50812	-3.41035
9	0.24749	7.74262	0.24446	-0.62561	11.02112	7.11701	18.76374
		-0.94382	-0.32844	0.62561	-11.02112	8.36823	-3.27850
9	0.26517	7.74358	0.24446	-0.48475	10.89141	7.25883	18.63499
		-0.94382	-0.32545	0.48475	-10.89141	8.22833	-3.14783
9	0.28284	7.74454	0.24446	-0.34390	10.76289	7.40065	18.50744
		-0.94382	-0.32245	0.34390	-10.76289	8.08844	-3.01835
9	0.30052	7.74551	0.24446	-0.20304	10.63557	7.54247	18.38107
		-0.94382	-0.31945	0.20304	-10.63557	7.94855	-2.89006
9	0.31820	7.74647	0.24446	-0.06219	10.50943	7.68428	18.25590
		-0.94382	-0.31646	0.06219	-10.50943	7.80865	-2.76296
9	0.33588	7.74743	0.24446	0.07867	10.38448	7.82610	18.13191
		-0.94382	-0.31346	-0.07867	-10.38448	7.66876	-2.63704
9	0.35355	7.74839	0.24446	0.21953	10.26071	7.96792	18.00911
		-0.94382	-0.31047	-0.21953	-10.26071	7.52887	-2.51232
9	0.37123	7.74936	0.24446	0.36038	10.13814	8.10974	17.88750
		-0.94382	-0.30747	-0.36038	-10.13814	7.38897	-2.38878
9	0.38891	7.75032	0.24446	0.50124	10.01675	8.25156	17.76707
		-0.94382	-0.30447	-0.50124	-10.01675	7.24908	-2.26644
9	0.40659	7.75128	0.24446	0.64209	9.89656	8.39337	17.64784
		-0.94382	-0.30148	-0.64209	-9.89656	7.10919	-2.14528
9	0.42426	7.75224	0.24446	0.78295	9.77755	8.53519	17.52979
		-0.94382	-0.29848	-0.78295	-9.77755	6.96929	-2.02531
11	0.00000	0.00000	0.00645	-0.00526	-0.00000	-0.00526	-0.00000
		0.00000	0.00000	0.00526	0.00000	0.00526	0.00000
11	0.00208	0.00000	0.00618	-0.00483	-0.00000	-0.00483	-0.00000
		0.00000	0.00000	0.00483	0.00000	0.00483	0.00000
11	0.00417	0.00000	0.00591	-0.00442	-0.00000	-0.00442	-0.00000
		0.00000	0.00000	0.00442	0.00000	0.00442	0.00000
11	0.00625	0.00000	0.00564	-0.00402	-0.00000	-0.00402	-0.00000
		0.00000	0.00000	0.00402	0.00000	0.00402	0.00000
11	0.00833	0.00000	0.00537	-0.00365	-0.00000	-0.00365	-0.00000
		0.00000	0.00000	0.00365	0.00000	0.00365	0.00000
11	0.01042	0.00000	0.00511	-0.00329	-0.00000	-0.00329	-0.00000
		0.00000	0.00000	0.00329	0.00000	0.00329	0.00000
11	0.01250	0.00000	0.00484	-0.00296	-0.00000	-0.00296	-0.00000
		0.00000	0.00000	0.00296	0.00000	0.00296	0.00000
11	0.01458	0.00000	0.00457	-0.00264	-0.00000	-0.00264	-0.00000
		0.00000	0.00000	0.00264	0.00000	0.00264	0.00000
11	0.01667	0.00000	0.00430	-0.00234	-0.00000	-0.00234	-0.00000
		0.00000	0.00000	0.00234	0.00000	0.00234	0.00000
11	0.01875	0.00000	0.00403	-0.00205	-0.00000	-0.00205	-0.00000
		0.00000	0.00000	0.00205	0.00000	0.00205	0.00000
11	0.02083	0.00000	0.00376	-0.00179	-0.00000	-0.00179	-0.00000
		0.00000	0.00000	0.00179	0.00000	0.00179	0.00000
11	0.02292	0.00000	0.00349	-0.00154	-0.00000	-0.00154	-0.00000
		0.00000	0.00000	0.00154	0.00000	0.00154	0.00000
11	0.02500	0.00000	0.00322	-0.00131	-0.00000	-0.00131	-0.00000
		0.00000	0.00000	0.00131	0.00000	0.00131	0.00000
11	0.02708	0.00000	0.00296	-0.00110	-0.00000	-0.00110	-0.00000
		0.00000	0.00000	0.00110	0.00000	0.00110	0.00000
11	0.02917	0.00000	0.00269	-0.00091	-0.00000	-0.00091	-0.00000
		0.00000	0.00000	0.00091	0.00000	0.00091	0.00000
11	0.03125	0.00000	0.00242	-0.00074	-0.00000	-0.00074	-0.00000
		0.00000	0.00000	0.00074	0.00000	0.00074	0.00000
11	0.03333	0.00000	0.00215	-0.00058	-0.00000	-0.00058	-0.00000
		0.00000	0.00000	0.00058	0.00000	0.00058	0.00000

11	0.03542	0.00000	0.00188	-0.00045	-0.00000	-0.00045	-0.00000
		0.00000	0.00000	0.00045	0.00000	0.00045	0.00000
11	0.03750	0.00000	0.00161	-0.00033	-0.00000	-0.00033	-0.00000
		0.00000	0.00000	0.00033	0.00000	0.00033	0.00000
11	0.03958	0.00000	0.00134	-0.00023	-0.00000	-0.00023	-0.00000
		0.00000	0.00000	0.00023	0.00000	0.00023	0.00000
11	0.04167	0.00000	0.00107	-0.00015	-0.00000	-0.00015	-0.00000
		0.00000	0.00000	0.00015	0.00000	0.00015	0.00000
11	0.04375	0.00000	0.00081	-0.00008	-0.00000	-0.00008	-0.00000
		0.00000	0.00000	0.00008	0.00000	0.00008	0.00000
11	0.04583	0.00000	0.00054	-0.00004	-0.00000	-0.00004	-0.00000
		0.00000	0.00000	0.00004	0.00000	0.00004	0.00000
11	0.04792	0.00000	0.00027	-0.00001	-0.00000	-0.00001	-0.00000
		0.00000	0.00000	0.00001	0.00000	0.00001	0.00000
11	0.05000	0.00000	-0.00000	-0.00000	-0.00000	-0.00000	-0.00000
		0.00000	0.00000	0.00000	0.00000	0.00000	0.00000
12	0.00000	-1.84143	-0.04984	1.07398	39.33410	-0.76745	37.49267
		0.51056	-18.70192	-1.07398	-39.33410	-2.91541	-41.17553
12	0.00295	-1.84159	-0.04984	1.06919	38.09755	-0.77240	36.25596
		0.51056	-18.70142	-1.06919	-38.09755	-2.91079	-39.93914
12	0.00589	-1.84175	-0.04984	1.06441	36.86104	-0.77734	35.01928
		0.51056	-18.70092	-1.06441	-36.86104	-2.90616	-38.70279
12	0.00884	-1.84191	-0.04984	1.05962	35.62455	-0.78229	33.78264
		0.51056	-18.70042	-1.05962	-35.62455	-2.90153	-37.46646
12	0.01179	-1.84207	-0.04984	1.05484	34.38810	-0.78724	32.54603
		0.51056	-18.69992	-1.05484	-34.38810	-2.89691	-36.23017
12	0.01473	-1.84223	-0.04984	1.05005	33.15168	-0.79218	31.30945
		0.51056	-18.69943	-1.05005	-33.15168	-2.89228	-34.99391
12	0.01768	-1.84239	-0.04984	1.04526	31.91530	-0.79713	30.07290
		0.51056	-18.69893	-1.04526	-31.91530	-2.88765	-33.75769
12	0.02062	-1.84255	-0.04984	1.04048	30.67894	-0.80208	28.83639
		0.51056	-18.69843	-1.04048	-30.67894	-2.88303	-32.52150
12	0.02357	-1.84271	-0.04984	1.03569	29.44262	-0.80702	27.59991
		0.51056	-18.69793	-1.03569	-29.44262	-2.87840	-31.28534
12	0.02652	-1.84287	-0.04984	1.03090	28.20634	-0.81197	26.36346
		0.51056	-18.69743	-1.03090	-28.20634	-2.87378	-30.04921
12	0.02946	-1.84303	-0.04984	1.02612	26.97008	-0.81692	25.12705
		0.51056	-18.69693	-1.02612	-26.97008	-2.86915	-28.81312
12	0.03241	-1.84319	-0.04984	1.02133	25.73386	-0.82187	23.89067
		0.51056	-18.69643	-1.02133	-25.73386	-2.86452	-27.57706
12	0.03536	-1.84336	-0.04984	1.01654	24.49768	-0.82681	22.65432
		0.51056	-18.69593	-1.01654	-24.49768	-2.85990	-26.34103
12	0.03830	-1.84352	-0.04984	1.01176	23.26152	-0.83176	21.41801
		0.51056	-18.69543	-1.01176	-23.26152	-2.85527	-25.10504
12	0.04125	-1.84368	-0.04984	1.00697	22.02540	-0.83671	20.18173
		0.51056	-18.69493	-1.00697	-22.02540	-2.85065	-23.86908
12	0.04419	-1.84384	-0.04984	1.00218	20.78931	-0.84165	18.94548
		0.51056	-18.69443	-1.00218	-20.78931	-2.84602	-22.63315
12	0.04714	-1.84400	-0.04984	0.99740	19.55326	-0.84660	17.70926
		0.51056	-18.69393	-0.99740	-19.55326	-2.84139	-21.39725
12	0.05009	-1.84416	-0.04984	0.99261	18.31724	-0.85155	16.47308
		0.51056	-18.69343	-0.99261	-18.31724	-2.83677	-20.16139
12	0.05303	-1.84432	-0.04984	0.98782	17.08125	-0.85649	15.23693
		0.51056	-18.69293	-0.98782	-17.08125	-2.83214	-18.92556
12	0.05598	-1.84448	-0.04984	0.98304	15.84529	-0.86144	14.00081
		0.51056	-18.69243	-0.98304	-15.84529	-2.82751	-17.68977
12	0.05893	-1.84464	-0.04984	0.97825	14.60937	-0.86639	12.76473
		0.51056	-18.69194	-0.97825	-14.60937	-2.82289	-16.45400
12	0.06187	-1.84480	-0.04984	0.97346	13.37348	-0.87134	11.52868
		0.51056	-18.69144	-0.97346	-13.37348	-2.81826	-15.21828
12	0.06482	-1.84496	-0.04984	0.96868	12.13762	-0.87628	10.29266
		0.51056	-18.69094	-0.96868	-12.13762	-2.81364	-13.98258
12	0.06776	-1.84512	-0.04984	0.96389	10.90180	-0.88123	9.05668
		0.51056	-18.69044	-0.96389	-10.90180	-2.80901	-12.74691
12	0.07071	-1.84528	-0.04984	0.95910	9.66600	-0.88618	7.82072
		0.51056	-18.68994	-0.95910	-9.66600	-2.80438	-11.51128
13	0.00000	-6.27203	-0.04984	0.95147	9.66600	-5.32056	3.39397
		-0.51894	-0.98774	-0.95147	-9.66600	-7.22350	-15.93803
13	0.03449	-6.27091	-0.04984	0.89545	8.90447	-5.37546	2.63357
		-0.51894	-0.98025	-0.89545	-8.90447	-7.16636	-15.17538
13	0.06897	-6.26979	-0.04984	0.83942	8.14874	-5.43036	1.87896
		-0.51894	-0.97276	-0.83942	-8.14874	-7.10921	-14.41853
13	0.10346	-6.26866	-0.04984	0.78340	7.39881	-5.48527	1.13014
		-0.51894	-0.96527	-0.78340	-7.39881	-7.05206	-13.66747
13	0.13794	-6.26754	-0.04984	0.72737	6.65467	-5.54017	0.38713
		-0.51894	-0.95778	-0.72737	-6.65467	-6.99491	-12.92221
13	0.17243	-6.26642	-0.04984	0.67135	5.91633	-5.59507	-0.35009
		-0.51894	-0.95029	-0.67135	-5.91633	-6.93776	-12.18274
13	0.20691	-6.26530	-0.04984	0.61532	5.18378	-5.64998	-1.08152

		-0.51894	-0.94280	-0.61532	-5.18378	-6.88061	-11.44907
13	0.24140	-6.26417	-0.04984	0.55929	4.45703	-5.70488	-1.80714
		-0.51894	-0.93531	-0.55929	-4.45703	-6.82347	-10.72120
13	0.27588	-6.26305	-0.04984	0.50327	3.73608	-5.75978	-2.52697
		-0.51894	-0.92782	-0.50327	-3.73608	-6.76632	-9.99913
13	0.31037	-6.26193	-0.04984	0.44724	3.02092	-5.81468	-3.24100
		-0.51894	-0.92033	-0.44724	-3.02092	-6.70917	-9.28285
13	0.34485	-6.26080	-0.04984	0.39122	2.31156	-5.86959	-3.94924
		-0.51894	-0.91284	-0.39122	-2.31156	-6.65202	-8.57237
13	0.37934	-6.25968	-0.04984	0.33519	1.60800	-5.92449	-4.65168
		-0.51894	-0.90535	-0.33519	-1.60800	-6.59487	-7.86768
13	0.41382	-6.25856	-0.04984	0.27917	0.91024	-5.97939	-5.34832
		-0.51894	-0.89786	-0.27917	-0.91024	-6.53773	-7.16880
13	0.44831	-6.25744	-0.04984	0.22314	0.21827	-6.03429	-6.03917
		-0.51894	-0.89037	-0.22314	-0.21827	-6.48058	-6.47571
13	0.48279	-6.25631	-0.04984	0.16712	-0.46790	-6.08920	-6.72422
		-0.51894	-0.88288	-0.16712	0.46790	-6.42343	-5.78841
13	0.51728	-6.25519	-0.04984	0.11109	-1.14828	-6.14410	-7.40347
		-0.51894	-0.87539	-0.11109	1.14828	-6.36628	-5.10691
13	0.55176	-6.25407	-0.04984	0.05507	-1.82286	-6.19900	-8.07692
		-0.51894	-0.86790	-0.05507	1.82286	-6.30913	-4.43121
13	0.58625	-6.25295	-0.04984	-0.00096	-2.49164	-6.25391	-8.74458
		-0.51894	-0.86041	0.00096	2.49164	-6.25199	-3.76131
13	0.62074	-6.25182	-0.04984	-0.05699	-3.15462	-6.30881	-9.40644
		-0.51894	-0.85292	0.05699	3.15462	-6.19484	-3.09720
13	0.65522	-6.25070	-0.04984	-0.11301	-3.81181	-6.36371	-10.06251
		-0.51894	-0.84543	0.11301	3.81181	-6.13769	-2.43889
13	0.68971	-6.24958	-0.04984	-0.16904	-4.46320	-6.41861	-10.71278
		-0.51894	-0.83794	0.16904	4.46320	-6.08054	-1.78638
13	0.72419	-6.24846	-0.04984	-0.22506	-5.10879	-6.47352	-11.35725
		-0.51894	-0.83045	0.22506	5.10879	-6.02339	-1.13966
13	0.75868	-6.24733	-0.04984	-0.28109	-5.74859	-6.52842	-11.99592
		-0.51894	-0.82296	0.28109	5.74859	-5.96624	-0.49874
13	0.79316	-6.24621	-0.04984	-0.33711	-6.38259	-6.58332	-12.62880
		-0.51894	-0.81547	0.33711	6.38259	-5.90910	0.13638
13	0.82765	-6.24509	-0.04984	-0.39314	-7.01080	-6.63823	-13.25588
		-0.51894	-0.80798	0.39314	7.01080	-5.85195	0.76571
14	0.00000	0.00000	0.00000	-0.00000	0.11206	-0.00000	0.11206
		0.00000	-0.05992	0.00000	-0.11206	0.00000	-0.11206
14	0.04167	0.00000	0.00000	-0.00000	0.06070	-0.00000	0.06070
		0.00000	-0.04993	0.00000	-0.06070	0.00000	-0.06070
14	0.08333	0.00000	0.00000	-0.00000	0.01868	-0.00000	0.01868
		0.00000	-0.03995	0.00000	-0.01868	0.00000	-0.01868
14	0.12500	0.00000	0.00000	0.00000	-0.01401	0.00000	-0.01401
		0.00000	-0.02996	-0.00000	0.01401	-0.00000	0.01401
14	0.16667	0.00000	0.00000	0.00000	-0.03735	0.00000	-0.03735
		0.00000	-0.01997	-0.00000	0.03735	-0.00000	0.03735
14	0.20833	0.00000	0.00000	0.00000	-0.05136	0.00000	-0.05136
		0.00000	-0.00999	-0.00000	0.05136	-0.00000	0.05136
14	0.25000	0.00000	-0.00000	0.00000	-0.05603	0.00000	-0.05603
		0.00000	-0.00000	-0.00000	0.05603	-0.00000	0.05603
14	0.29167	0.00000	-0.00000	0.00000	-0.05136	0.00000	-0.05136
		0.00000	0.00999	-0.00000	0.05136	-0.00000	0.05136
14	0.33333	0.00000	-0.00000	0.00000	-0.03735	0.00000	-0.03735
		0.00000	0.01997	-0.00000	0.03735	-0.00000	0.03735
14	0.37500	0.00000	-0.00000	0.00000	-0.01401	0.00000	-0.01401
		0.00000	0.02996	-0.00000	0.01401	-0.00000	0.01401
14	0.41667	0.00000	-0.00000	-0.00000	0.01868	-0.00000	0.01868
		0.00000	0.03995	0.00000	-0.01868	0.00000	-0.01868
14	0.45833	0.00000	-0.00000	-0.00000	0.06070	-0.00000	0.06070
		0.00000	0.04993	0.00000	-0.06070	0.00000	-0.06070
14	0.50000	0.00000	0.00000	-0.00000	0.00700	-0.00000	0.00700
		0.00000	-0.01498	0.00000	-0.00700	0.00000	-0.00700
14	0.51042	0.00000	0.00000	-0.00000	0.00379	-0.00000	0.00379
		0.00000	-0.01248	0.00000	-0.00379	0.00000	-0.00379
14	0.52083	0.00000	0.00000	-0.00000	0.00117	-0.00000	0.00117
		0.00000	-0.00999	0.00000	-0.00117	0.00000	-0.00117
14	0.53125	0.00000	0.00000	0.00000	-0.00088	0.00000	-0.00088
		0.00000	-0.00749	-0.00000	0.00088	-0.00000	0.00088
14	0.54167	0.00000	0.00000	0.00000	-0.00233	0.00000	-0.00233
		0.00000	-0.00499	-0.00000	0.00233	-0.00000	0.00233
14	0.55208	0.00000	0.00000	0.00000	-0.00321	0.00000	-0.00321
		0.00000	-0.00250	-0.00000	0.00321	-0.00000	0.00321
14	0.56250	0.00000	-0.00000	0.00000	-0.00350	0.00000	-0.00350
		0.00000	-0.00000	-0.00000	0.00350	-0.00000	0.00350
14	0.57292	0.00000	-0.00000	0.00000	-0.00321	0.00000	-0.00321
		0.00000	0.00250	-0.00000	0.00321	-0.00000	0.00321
14	0.58333	0.00000	-0.00000	0.00000	-0.00233	0.00000	-0.00233
		0.00000	0.00499	-0.00000	0.00233	-0.00000	0.00233
14	0.59375	0.00000	-0.00000	0.00000	-0.00088	0.00000	-0.00088

		0.00000	0.00749	-0.00000	0.00088	-0.00000	0.00088
14	0.60417	0.00000	-0.00000	-0.00000	0.00117	-0.00000	0.00117
		0.00000	0.00999	0.00000	-0.00117	0.00000	-0.00117
14	0.61458	0.00000	-0.00000	-0.00000	0.00379	-0.00000	0.00379
		0.00000	0.01248	0.00000	-0.00379	0.00000	-0.00379
14	0.62500	0.00000	-0.00000	-0.00000	0.00700	-0.00000	0.00700
		0.00000	0.01498	0.00000	-0.00700	0.00000	-0.00700
15	0.00000	1.71862	-0.19461	2.38247	43.79508	4.10109	45.51370
		1.77004	5.35096	-2.38247	-43.79508	-0.66385	-42.07646
15	0.00295	1.71878	-0.19461	2.36378	44.14890	4.08256	45.86768
		1.77004	5.35146	-2.36378	-44.14890	-0.64500	-42.43012
15	0.00589	1.71894	-0.19461	2.34509	44.50276	4.06403	46.22170
		1.77004	5.35196	-2.34509	-44.50276	-0.62615	-42.78381
15	0.00884	1.71910	-0.19461	2.32640	44.85664	4.04550	46.57574
		1.77004	5.35246	-2.32640	-44.85664	-0.60730	-43.13754
15	0.01179	1.71926	-0.19461	2.30771	45.21056	4.02697	46.92982
		1.77004	5.35296	-2.30771	-45.21056	-0.58845	-43.49130
15	0.01473	1.71942	-0.19461	2.28902	45.56452	4.00844	47.28394
		1.77004	5.35346	-2.28902	-45.56452	-0.56960	-43.84509
15	0.01768	1.71958	-0.19461	2.27033	45.91850	3.98991	47.63808
		1.77004	5.35396	-2.27033	-45.91850	-0.55075	-44.19892
15	0.02062	1.71974	-0.19461	2.25164	46.27252	3.97139	47.99226
		1.77004	5.35446	-2.25164	-46.27252	-0.53190	-44.55278
15	0.02357	1.71990	-0.19461	2.23295	46.62657	3.95286	48.34648
		1.77004	5.35496	-2.23295	-46.62657	-0.51305	-44.90667
15	0.02652	1.72006	-0.19461	2.21426	46.98066	3.93433	48.70072
		1.77004	5.35546	-2.21426	-46.98066	-0.49420	-45.26059
15	0.02946	1.72022	-0.19461	2.19557	47.33478	3.91580	49.05500
		1.77004	5.35595	-2.19557	-47.33478	-0.47535	-45.61455
15	0.03241	1.72038	-0.19461	2.17688	47.68893	3.89727	49.40931
		1.77004	5.35645	-2.17688	-47.68893	-0.45650	-45.96854
15	0.03536	1.72054	-0.19461	2.15820	48.04311	3.87874	49.76366
		1.77004	5.35695	-2.15820	-48.04311	-0.43765	-46.32257
15	0.03830	1.72071	-0.19461	2.13951	48.39733	3.86021	50.11803
		1.77004	5.35745	-2.13951	-48.39733	-0.41880	-46.67662
15	0.04125	1.72087	-0.19461	2.12082	48.75158	3.84168	50.47244
		1.77004	5.35795	-2.12082	-48.75158	-0.39995	-47.03071
15	0.04419	1.72103	-0.19461	2.10213	49.10586	3.82315	50.82689
		1.77004	5.35845	-2.10213	-49.10586	-0.38110	-47.38484
15	0.04714	1.72119	-0.19461	2.08344	49.46018	3.80462	51.18136
		1.77004	5.35895	-2.08344	-49.46018	-0.36225	-47.73899
15	0.05009	1.72135	-0.19461	2.06475	49.81453	3.78610	51.53587
		1.77004	5.35945	-2.06475	-49.81453	-0.34340	-48.09318
15	0.05303	1.72151	-0.19461	2.04606	50.16891	3.76757	51.89042
		1.77004	5.35995	-2.04606	-50.16891	-0.32455	-48.44740
15	0.05598	1.72167	-0.19461	2.02737	50.52332	3.74904	52.24499
		1.77004	5.36045	-2.02737	-50.52332	-0.30570	-48.80166
15	0.05893	1.72183	-0.19461	2.00868	50.87777	3.73051	52.59960
		1.77004	5.36095	-2.00868	-50.87777	-0.28685	-49.15594
15	0.06187	1.72199	-0.19461	1.98999	51.23225	3.71198	52.95424
		1.77004	5.36145	-1.98999	-51.23225	-0.26800	-49.51027
15	0.06482	1.72215	-0.19461	1.97130	51.58677	3.69345	53.30892
		1.77004	5.36195	-1.97130	-51.58677	-0.24915	-49.86462
15	0.06776	1.72231	-0.19461	1.95261	51.94132	3.67492	53.66362
		1.77004	5.36245	-1.95261	-51.94132	-0.23030	-50.21901
15	0.07071	1.72247	-0.19461	1.93392	52.29590	3.65639	54.01837
		1.77004	5.36295	-1.93392	-52.29590	-0.21145	-50.57343
16	0.00000	1.07540	-0.19461	3.66026	-6.88213	4.73566	-5.80673
		2.25881	6.69658	-3.66026	6.88213	-2.58486	7.95753
16	0.00466	1.07556	-0.19461	3.63071	-6.18199	4.70627	-5.10642
		2.25881	6.69758	-3.63071	6.18199	-2.55515	7.25755
16	0.00932	1.07572	-0.19461	3.60116	-5.48174	4.67688	-4.40601
		2.25881	6.69858	-3.60116	5.48174	-2.52543	6.55746
16	0.01398	1.07588	-0.19461	3.57161	-4.78138	4.64749	-3.70550
		2.25881	6.69958	-3.57161	4.78138	-2.49572	5.85727
16	0.01863	1.07605	-0.19461	3.54206	-4.08093	4.61810	-3.00488
		2.25881	6.70058	-3.54206	4.08093	-2.46601	5.15697
16	0.02329	1.07621	-0.19461	3.51251	-3.38037	4.58871	-2.30416
		2.25881	6.70158	-3.51251	3.38037	-2.43630	4.45657
16	0.02795	1.07637	-0.19461	3.48296	-2.67970	4.55932	-1.60333
		2.25881	6.70258	-3.48296	2.67970	-2.40659	3.75607
16	0.03261	1.07653	-0.19461	3.45341	-1.97893	4.52993	-0.90240
		2.25881	6.70358	-3.45341	1.97893	-2.37688	3.05546
16	0.03727	1.07669	-0.19461	3.42386	-1.27806	4.50054	-0.20137
		2.25881	6.70457	-3.42386	1.27806	-2.34717	2.35474
16	0.04193	1.07685	-0.19461	3.39431	-0.57708	4.47115	0.49977
		2.25881	6.70557	-3.39431	0.57708	-2.31746	1.65392
16	0.04658	1.07701	-0.19461	3.36476	0.12401	4.44176	1.20101
		2.25881	6.70657	-3.36476	-0.12401	-2.28775	0.95300
16	0.05124	1.07717	-0.19461	3.33520	0.82519	4.41237	1.90236

0.51894	-0.80798	-0.39314	7.01080	-6.63823	0.76571
---------	----------	----------	---------	----------	---------